

Adaptors and Manifolds





A Complete Range of Adaptors

Brass Adaptors

0143
BSPP
Page 9-7



0144
BSPT/BSPP
Page 9-7



0152
BSPT
Page 9-7



0145
BSPP
Page 9-7



MR0434
BSPP/BSPT
Page 9-7



0158
BSPT/BSPP
Page 9-8



0117
BSPP
Page 9-8



207ACBH
NPTF
Page 9-8



0155
BSPP
Page 9-8



GG-B
NPTF
Page 9-9



207P
NPTF
Page 9-9



0164
NPT/BSPP
Page 9-9



0167
BSPT/NPT
Page 9-9



0168
BSPP
Page 9-9



0163
BSPT/BSPP
Page 9-10



209P
NPTF
Page 9-10



0169
BSPP
Page 9-10



FG43
BSPP/BSPT
Page 9-10



222P
NPTF
Page 9-11



0121
BSPT
Page 9-11



FF44
BSPP
Page 9-11



0121
NPT/BSPT
Page 9-11



216P
NPTF
Page 9-12



0929
BSPT
Page 9-12



0123
BSPT
Page 9-12



0136
BSPT
Page 9-13



Nickel-Plated Brass Adaptors

0912
BSPT/Metric
Page 9-14



DD44BKTL
BSPP
Page 9-14



0921
Metric
Page 9-14



0913
BSPT/BSPP
Page 9-14



0922
Metric
Page 9-14



0914
BSPT
Page 9-15



0910
BSPP
Page 9-15



0911
BSPT/BSPP
Page 9-15



0915
BSPP/Metric
Page 9-15



0923
Metric
Page 9-15



0916
BSPT/BSPP
Page 9-16



0924
Metric
Page 9-16



0917
BSPT/BSPP
Page 9-16



0927
BSPT
Page 9-16



0928
BSPT/BSPP
Page 9-16



0932
BSPT/BSPP
Page 9-17



0908
BSPP
Page 9-17



0909
BSPT/BSPP
Page 9-17



KRRS3
BSPT
Page 9-17



0903
BSPT/BSPP
Page 9-17



0904
BSPT/BSPP
Page 9-18



0905
BSPP/Metric
Page 9-18



0906
BSPT/Metric
Page 9-18



0933
BSPT/BSPP
Page 9-18



0907
BSPP
Page 9-19



0920
BSPP/Metric
Page 9-19



0900
BSPT
Page 9-19



0901
BSPT/Metric
Page 9-19



0192
BSPT/BSPP
Page 9-20



0902
BSPT/Metric
Page 9-20



0191
BSPP
Page 9-20



0931
BSPP
Page 9-20



0934
BSPT
Page 9-21



0935
BSPP
Page 9-21



Stainless Steel Adaptors

1844
BSPT/BSPP
Page 9-22



1843
BSPP
Page 9-22



1845
BSPP
Page 9-22



1817
BSPP
Page 9-22



1871
NPT
Page 9-22



1855
BSPP
Page 9-23



1870
NPT
Page 9-23



1862
BSPP
Page 9-23



1864
NPT/BSPP
Page 9-23



1867
BSPT/NPT
Page 9-23



1863
BSPT/BSPP
Page 9-24



1872
NPT
Page 9-24



1861
BSPT/BSPP
Page 9-24



1873
NPT
Page 9-24



1821
BSPT
Page 9-24



1821
NPT
Page 9-25



1823
BSPT
Page 9-25



1823
NPT
Page 9-25



A Complete Range of Manifolds, Plugs and Accessories

Brass and Aluminium Manifolds



Brass Plugs



Nickel-Plated Brass Hollow Hex Plug



Steel Plugs



Stainless Steel Plugs



Sealing Accessories



Tube Supports



Adaptors, Plugs and Manifolds

Parker Legris offers a **wide range of adaptors and manifolds** compatible with the various Parker Legris fitting systems. This range of products provides the user with a **complete solution** covering numerous applications, both in non-corrosive and corrosive environments.

Product Advantages

Large Range & Flexibility

A complete offer, from the simple adaptor to a modular manifold solution

Large selection of materials for excellent chemical compatibility: brass, steel, stainless steel, aluminium

Surface treatment for increased corrosion resistance: nickel-plated brass or anodised aluminium

Stainless steel for corrosive environments

BSPP, BSPT, NPT, NPTF and metric threads

Performance

Robust design

Suitable for low to high pressure, depending on configuration and material

Forged shapes for mechanical strength



Applications

- Packaging
- Robotics
- Textile
- Pneumatics
- Automotive Process
- Food Process

Technical Characteristics

Products	Adaptors and Plugs				Manifolds
Component Materials	Brass	Nickel-plated brass	Stainless steel 316L	Steel	Anodised aluminium
Working Pressure	1/8" to 1/2": 200 bar 3/4" and 1": 150 bar 1 1/4" to 2": 100 bar, without sealing washer	60 bar	1/8" to 1/2": 200 bar 3/4" and 1": 150 bar 1 1/4" to 2": 100 bar, without sealing washer	1/8" to 1/2": 200 bar 3/4" and 1": 150 bar 1 1/4" to 2": 100 bar, without sealing washer	20 bar
Working Temperature	-60°C to +150°C without sealing washer -20°C to +100°C with sealing washer	-10°C to +80°C	-20°C to +180°C	-10°C to +80°C	-10°C to +80°C

Thread sealing must be guaranteed by user.

Brass Adaptors

0143 Equal Threaded Elbow, Female BSPP Thread

Brass

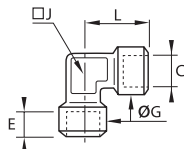

C		E	G	J	L	Kg
G1/8	0143 10 10	7.5	16.5	12	22.5	0.043
G1/4	0143 13 13	11	18.5	15	26.5	0.057
G3/8	0143 17 17	11.5	23.5	19	31.5	0.102
G1/2	0143 21 21	15	28	23	34.5	0.150
G3/4	0143 27 27	16.5	34	27	43.5	0.247

0144 Equal Stud Elbow, Male BSPT/Female BSPP Thread

Brass

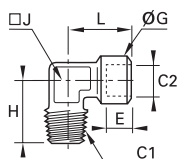

C1	C2		E	G	H	J	L	Kg
R1/8	G1/8	0144 10 10	7.5	16.5	23	12	22.5	0.035
R1/4	G1/4	0144 13 13	11	18.5	26	15	26.5	0.052
R3/8	G3/8	0144 17 17	11.5	23.5	30	19	31.5	0.086
R1/2	G1/2	0144 21 21	15	28	35	23	34.5	0.140
R3/4	G3/4	0144 27 27	16.5	34	40	27	43.5	0.232

0152 Equal Elbow, Male BSPT Thread

Brass

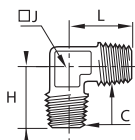

C		H	J	L	Kg
R1/8	0152 10 10	19.5	10	19.5	0.018
R1/4	0152 13 13	25	15	25	0.045
R3/8	0152 17 17	26.5	15	26.5	0.054
R1/2	0152 21 21	31.5	19	31.5	0.088
R3/4	0152 27 27	35.5	23	35.5	0.153

0145 Equal Tee, Female BSPP Thread

Brass

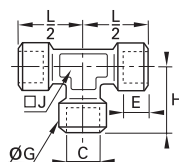

C		E	G	H	J	L/2	Kg
G1/8	0145 10 10	7.5	16.5	22.5	12	22.5	0.057
G1/4	0145 13 13	11	18.5	26.5	15	26.5	0.079
G3/8	0145 17 17	11.5	23.5	31	19	31	0.126
G1/2	0145 21 21	15	28	38	23	38	0.244
G3/4	0145 27 27	16.5	34	47.5	27	47.5	0.370

MR0434 Stud Run Tee, Female BSPP/Male BSPT Thread

Brass

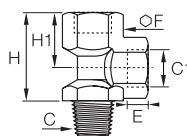

C	C1		E	F	H	H1	H2	Kg
R1/8	G1/8	1/8MR0434B	8	14	32	17	15	0.029
R1/4	G1/4	1/4MR0434B	10	17	40	22	18	0.051
R3/8	G3/8	3/8MR0434B	12	24	49	25	24	0.127
R1/2	G1/2	1/2MR0434B	14	30	63	32	31	0.254

Brass Adaptors

0158

Stud Branch Tee, Male BSPT/Female BSPP Thread

Brass

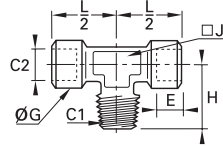

C1	C2		E	G	H	J	L/2	Kg
R1/8	G1/8	0158 10 10	7.5	16.5	21.5	12	21.5	0.046
R1/4	G1/4	0158 13 13	11	18.5	26	15	26	0.075
R3/8	G3/8	0158 17 17	11.5	23.5	30	19	30	0.120
R1/2	G1/2	0158 21 21	15	28	36	23	36	0.204
R3/4	G3/4	0158 27 27	16.5	34	44	27	44	0.310

0117

Equal Bulkhead Coupling, Female BSPP and Metric Thread

Brass

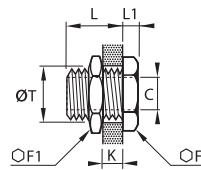

C		F	F1	K _{max}	L	L1	ØT	Kg
M5x0.8	0117 00 19	14	14	7	10.5	3.5	10.5	0.012
G1/8	0117 00 10	19	22	9	14	4	16.5	0.033
G1/4	0117 00 13	24	27	15	21	4	20.5	0.056
G3/8	0117 00 17	30	32	14	21	5	26.5	0.096
G1/2	0117 00 21	32	36	20	27	6	28.5	0.115
G3/4	0117 00 27	41	41	22.5	30	6	34.5	0.161
G1	0117 00 34	46	50	24.5	34	8	42.5	0.266
G1 1/4	0117 00 42	55	55	29.5	39	8	49.5	0.303
G1 1/2	0117 00 49	60	60	29.5	39	8	54.5	0.303

207ACBH

Bulkhead Union, Female NPTF Thread

Brass

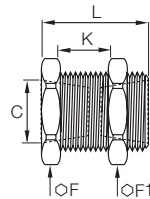

C		F*	F1*	K	L	Kg
NPTF1/8*	207ACBH-2	7/8	15/16	20	38	0.073
NPTF1/4	207ACBH-4	1	1.1/8	18	38	0.101
NPTF3/8	207ACBH-6	1.1/8	1.1/4	13	34	0.127
NPTF1/2	207ACBH-8	1.1/4	1.3/8	16	38	0.158

*Inch dimensions

0155

Equal Connector, Female BSPP Thread

Brass

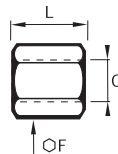

C	C1		F	L	Kg
G1/8	G1/8	0155 10 10	14	17	0.014
G1/4	G1/8	0155 10 13	17	18	0.023
G3/8	G1/8	0155 10 17	22	20	0.045
G1/2	G1/8	0155 10 21	27	22	0.075
G1/4	G1/4	0155 13 13	17	24	0.025
G3/8	G1/4	0155 13 17	22	22	0.046
G1/2	G1/4	0155 13 21	27	24	0.079
G3/8	G3/8	0155 17 17	22	25	0.045
G1/2	G3/8	0155 17 21	17	26	0.048
G1/2	G1/2	0155 21 21	27	32	0.084
G3/4	G3/4	0155 27 27	32	35	0.109
G1	G1	0155 34 34	41	36	0.194

Brass Adaptors

GG-B

Equal Adaptor, Female NPTF Thread, Heavy Series

Brass

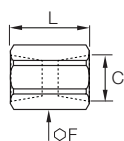

C



F*

L

Kg

NPTF1/8	1/8 GG-B	5/8	19	0.018
---------	--------------------------	-----	----	-------

*Inch dimensions
Max. working pressure: 260 bar

207P

Equal Adaptor, Female NPTF Thread

Brass

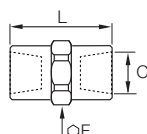

C



F*

L

Kg

NPTF1/8	207P-2	9/16	19	0.017
NPTF1/4	207P-4	3/4	28	0.040
NPTF3/8	207P-6	7/8	28	0.054
NPTF1/2	207P-8	1.1/16	38	0.088

*Inch dimensions

0164

Adaptor, Male NPT/Female BSPP Thread

Brass

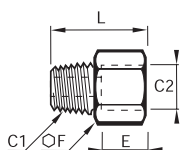

C1

C2



E

F

L

Kg

NPT1/8	G1/8	0164 11 10	7.5	14	20	0.015
NPT1/4	G1/4	0164 14 13	11	17	27.5	0.028
NPT3/8	G3/8	0164 18 17	11.5	22	28.5	0.044
NPT1/2	G1/2	0164 22 21	15	27	36.5	0.082
NPT3/4	G3/4	0164 28 27	16.5	32	38.5	0.110

0167

Adaptor, Male BSPT/Female NPT Thread

Brass

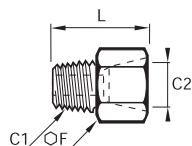

C1

C2



F

L

Kg

R1/8	NPT1/8	0167 10 11	14	21	0.016
R1/4	NPT1/4	0167 13 14	17	28.5	0.029
R3/8	NPT3/8	0167 17 18	22	29.5	0.047
R1/2	NPT1/2	0167 21 22	27	37.5	0.088
R3/4	NPT3/4	0167 27 28	32	39.5	0.120

0168

Reducer, Male BSPP/Female BSPP and Metric Thread

Brass, technical polymer

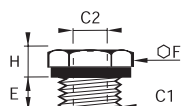

C1

C2



E

F

H

Kg

G1/8	M5x0.8	0168 10 19	7	14	6	0.009
G1/4	M5x0.8	0168 13 19	7	17	7	0.017
	G1/8	0168 13 10	7	17	7	0.011
G3/8	G1/8	0168 17 10	9	19	6	0.019
	G1/4	0168 17 13	9	19	6	0.013
	G1/8	0168 21 10	11	24	10	0.051
G1/2	G1/4	0168 21 13	11	24	10	0.042
	G3/8	0168 21 17	11	24	10	0.030
	G1/4	0168 27 13	11	32	12	0.098
G3/4	G3/8	0168 27 17	11	32	12	0.085
	G1/2	0168 27 21	11	32	12	0.063

With fitted captive seal

Brass Adaptors

0163

Unequal Reducer, Male BSPT/Female BSPP Thread

Brass

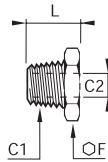

C1	C2		F	L	Kg
R1/4	G1/8	0163 13 10	14	16	0.009
R3/8	G1/8	0163 17 10	17	16.5	0.020
	G1/4	0163 17 13	17	16.5	0.012
R1/2	G1/8	0163 21 10	22	21	0.048
	G1/4	0163 21 13	22	21	0.038
	G3/8	0163 21 17	22	21	0.025
R3/4	G1/4	0163 27 13	27	24	0.085
	G3/8	0163 27 17	27	24	0.069
	G1/2	0163 27 21	27	24	0.046
R1	G1/2	0163 34 21	36	27	0.137
	G3/4	0163 34 27	36	27	0.092

209P

Reducer, Male/Female NPTF Thread

Brass

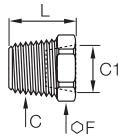

C	C1		F*	L	Kg
NPTF1/4	NPTF1/8	209P-4-2	9/16	19	0.012
NPTF3/8	NPTF1/8	209P-6-2	11/16	18	0.025
	NPTF1/4	209P-6-4	11/16	19	0.179
	NPTF1/8	209P-8-2	7/8	25	0.049
NPTF1/2	NPTF1/4	209P-8-4	7/8	26	0.049
	NPTF3/8	209P-8-6	7/8	26	0.033
	NPTF1/4	209P-12-4	1.1/8	25	0.080
NPTF3/4	NPTF3/8	209P-12-6	1.1/8	26	0.080
	NPTF1/2	209P-12-8	1.1/8	26	0.057

*Inch dimensions

0169

Increaser, Male/Female BSPP Thread

Brass, technical polymer

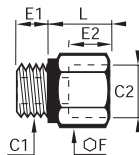

C1	C2		E1	E2	F	L	Kg
G1/8	G1/4	0169 10 13	5	11	17	16	0.019
	G3/8	0169 10 17	5	14	22	19.5	0.038
G1/4	G3/8	0169 13 17	7	14	22	19.5	0.042
	G1/2	0169 13 21	7	14.5	27	20.5	0.061
G3/8	G1/2	0169 17 21	8	14.5	27	20.5	0.062
	G3/4	0169 17 27	8	15.5	32	22	0.082
G1/2	G3/4	0169 21 27	9.5	15.5	32	22.5	0.087

With fitted captive seal

FG43

Reducer, Female BSPP/Male BSPT Thread

Brass

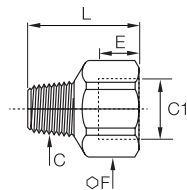

C	C1		E	F	L	Kg
R1/8	G1/4	1/4X1/8FG43B	11	17	21.5	0.020
	G3/8	3/8X1/8FG43B	12	22	25	0.035
	G1/2	1/2X1/8FG43B	15	27	28	0.063
R1/4	G3/8	3/8X1/4FG43B	12	22	28	0.040
	G1/2	1/2X1/4FG43B	15	27	30	0.071
R3/8	G1/2	1/2X3/8FG43B	15	27	29	0.066
R1/2	G3/4	3/4X1/2FG43B	16	32	39	0.113
R3/4	G1	1X3/4FG43B	18	41	38	0.168

Brass Adaptors

222P

Reducer, Female/Male NPTF Thread

Brass

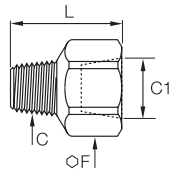

C	C1		F*	L	Kg
NPTF1/8	NPTF1/8	222P-2-2	9/16	22	0.017
NPTF1/8	NPTF1/4	222P-4-2	3/4	27	0.021
NPTF1/4	NPTF1/4	222P-4-4	3/4	32	0.039
NPTF1/4	NPTF3/8	222P-6-4	7/8	32	0.046
NPTF3/8	NPTF3/8	222P-6-6	7/8	32	0.044
NPTF1/4	NPTF1/2	222P-8-4	1	37	0.076
NPTF3/8	NPTF1/2	222P-8-6	1 1/16	37	0.083

*Inch dimensions

0121

Equal/Unequal Straight Male Adaptor, Male BSPT Thread

Brass

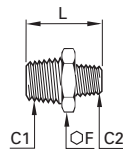

C1	C2		F	L	Kg
R1/8	R1/8	0121 10 10	11	19	0.009
R1/8	R1/8	0121 13 10	14	23.5	0.017
R1/4	R1/4	0121 13 13	14	27	0.020
R1/8	R1/8	0121 17 10	17	24	0.022
R3/8	R1/4	0121 17 13	17	27.5	0.025
R3/8	R3/8	0121 17 17	17	28	0.026
R1/8	R1/8	0121 21 10	22	28.5	0.043
R1/4	R1/4	0121 21 13	22	32	0.045
R3/8	R3/8	0121 21 17	22	32.5	0.045
R1/2	R1/2	0121 21 21	22	36	0.053
R1/4	R1/4	0121 27 13	27	35	0.077
R3/8	R3/8	0121 27 17	27	35.5	0.077
R3/4	R1/2	0121 27 21	27	39	0.083
R3/4	R3/4	0121 27 27	27	40	0.090
R3/8	R3/8	0121 34 17	36	38.5	0.127
R1	R1/2	0121 34 21	36	42	0.136
R3/4	R3/4	0121 34 27	36	43	0.143
R1	R1	0121 34 34	36	46	0.152
R1/2	R1/2	0121 42 21	46	46.5	0.217
R3/4	R3/4	0121 42 27	46	47.5	0.229
R1 1/4	R1	0121 42 34	46	50.5	0.239
R1 1/4	R1 1/4	0121 42 42	46	53	0.230

FF44

Equal Adaptor, Male BSPP Thread

Brass

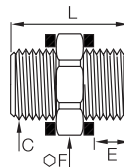

C		E	F	L	Kg
G1/8	1/8FF44B	6	14	19	0.018
G1/4	1/4FF44B	7	17	22	0.022
G3/8	3/8FF44B	8	22	24	0.040
G1/2	1/2FF44B	10	27	31	0.077

These parts are supplied with two copper seals.

0121

Equal Adaptor, Male NPT/BSPT Thread

Brass

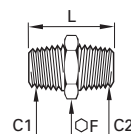

C1	C2		F	L	Kg
NPT1/8	R1/8	0121 11 10	11	19	0.009
NPT1/4	R1/4	0121 14 13	14	27	0.020
NPT3/8	R3/8	0121 18 17	17	28	0.026
NPT1/2	R1/2	0121 22 21	22	36	0.052
NPT3/4	R3/4	0121 28 27	27	40	0.090

Brass Adaptors

216P

Equal Adaptor, Male NPTF Thread

Brass

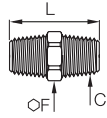

C	C1		F*	L	Kg
NPTF1/8	NPTF1/8	216P-2	7/16	25	0.008
NPTF3/8	NPTF1/8	216P-6-2	11/16	31	0.028
NPTF1/4	NPTF1/4	216P-4	9/16	35	0.025
	NPTF1/8	216P-4-2	9/16	30	0.001
NPTF3/8	NPTF3/8	216P-6	11/16	36	0.029
	NPTF1/4	216P-6-4	11/16	36	0.033
	NPTF1/4	216P-8-4	7/8	41	0.057
NPTF1/2	NPTF1/2	216P-8	7/8	46	0.064
	NPTF3/8	216P-8-6	7/8	41	0.056

*Inch dimensions

0929

Equal 3-Piece Adaptor, Male BSPT Thread

Brass, NBR

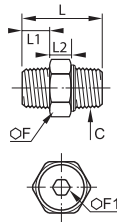

C		F	F1	L	L1	L2	Kg
R1/8	0929 01 10	15	5	27	7.5	8.5	0.017
R1/4	0929 01 13	19	6	33.5	11	9.5	0.035
R3/8	0929 01 17	22	8	36.5	11.5	10	0.055
R1/2	0929 01 21	27	12	45	14	12	0.089
R3/4	0929 01 27	36	14	52.5	16.5	17	0.261
R1	0929 01 34	46	19	63.5	19	20	0.600

This connection accessory makes assembly much easier thanks to its 3-piece design.

To join 2 threaded components, simply push together and tighten the sleeve nut, thus reducing installation time.

Maximum working pressure: 50 bar

Working temperature: -10° to +80°C

Supplied with seal

0123

Tailpiece Adaptor for Rubber Hose, Male BSPT Thread

Brass

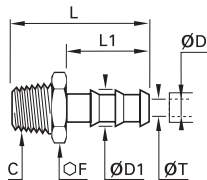

ØD	ØD1	C		F	L	L1	ØT	Kg
4	6	R1/8	0123 04 10	10	34	22.5	3.3	0.008
6	8	R1/8	0123 06 10	10	34	22.5	5	0.009
7	9	R1/8	0123 07 10	10	34	22.5	5	0.009
		R1/4	0123 07 13	14	38.5	22.5	6	0.018
		R3/8	0123 07 17	17	39	22.5	6	0.024
10	12.2	R1/8	0123 10 10	13	34	22.5	5	0.014
		R1/4	0123 10 13	14	38.5	22.5	7	0.020
12	14	R3/8	0123 10 17	17	39	22.5	9.5	0.023
		R3/8	0123 12 17	17	46	29.5	11	0.026
13	15	R1/4	0123 13 13	17	45.5	29.5	7	0.026
		R3/8	0123 13 17	17	46	29.5	11	0.027
		R1/2	0123 13 21	22	50.5	29.5	12	0.045
16	18.5	R3/8	0123 16 17	19	54.5	38	11	0.038
		R1/2	0123 16 21	22	59	38	14	0.054
		R3/4	0123 16 27	27	62	38	15	0.084
19	21.5	R3/8	0123 19 17	22	54.5	38	11	0.047
		R1/2	0123 19 21	22	59	38	14	0.057
		R3/4	0123 19 27	27	62	38	18	0.082
25	26.7	R3/4	0123 25 27	27	62	38	18	0.078
	27	R1	0123 25 34	36	65	38	24	0.126
32	34.5	R1	0123 32 34	36	70	43	24	0.142

Brass Adaptors

0136

Tailpiece Adaptor for Flexible Tubing, Male BSPT Thread

Brass

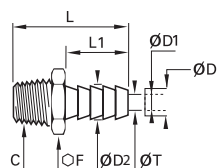

ØD	ØD1	ØD2	C		F	L	L1	ØT	Kg
6	4	4.3	R1/8	0136 06 10	10	26.5	15	2	0.007
		4.3	R1/4	0136 06 13	14	31	15	2	0.015
		4.3	R3/8	0136 06 17	17	31.5	15	2	0.019
8	6	6.4	R1/8	0136 08 10	10	26.5	15	4	0.007
		6.4	R1/4	0136 08 13	14	31	15	4	0.015
		6.4	R3/8	0136 08 17	17	31.5	15	4	0.020
10	8	8.4	R1/4	0136 10 13	14	31	15	6	0.016
		8.4	R3/8	0136 10 17	17	31.5	15	6	0.020
		8.4	R1/2	0136 10 21	22	36	15	6	0.039
12	10	10.7	R1/4	0136 12 13	14	36	20	7	0.018
		10.7	R3/8	0136 12 17	17	36.5	20	8	0.023
		10.7	R1/2	0136 12 21	22	41	20	8	0.040
14	12	12.7	R1/4	0136 14 13	14	36	20	7	0.019
		12.7	R3/8	0136 14 17	17	36.5	20	10	0.023
		12.7	R1/2	0136 14 21	22	41	20	10	0.040
16	13	12.7	R3/4	0136 14 27	27	44	20	10	0.071
		13.7	R3/8	0136 16 17	17	36.5	20	11	0.023
		13.7	R1/2	0136 16 21	22	41	20	11	0.040
		13.7	R3/4	0136 16 27	27	44	20	11	0.071

Nickel-Plated Brass Adaptors

0912 Equal Stud Elbow, Female BSPP and Metric Thread

Nickel-plated brass

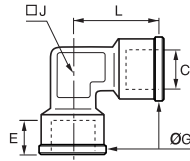

C		E	G	J	L	Kg
M5x0.8	0912 00 19	4	8	9	11	0.006
G1/8	0912 00 10	8	13	10	18.5	0.015
G1/4	0912 00 13	11.5	17	12	22.5	0.028
G3/8	0912 00 17	11.5	21	15	25.5	0.043
G1/2	0912 00 21	14	26	19	30	0.074
G3/4	0912 00 27	16.5	32	22	35.5	0.101
G1	0912 00 34	18	38.5	28	40.5	0.168

DD44BKTL

90° Bracketed Equal Elbow, Female BSPP Thread

Nickel-plated brass

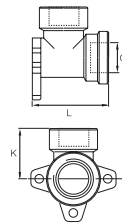

C		K	L	Kg
G1/2	1/2DD44BKTL	27	40.5	0.061

0921 Equal Stud Elbow, Male/Female and Metric Thread

Nickel-plated brass

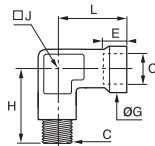

C		E	G	H	J	L	Kg
M5x0.8	0921 00 19	4	8	11.5	9	11	0.007

0913 Equal Stud Elbow, Male BSPT/ Female BSPP Thread

Nickel-plated brass

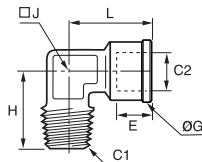

C1	C2		E	G	H	J	L	Kg
R1/8	G1/8	0913 00 10	8	13	17	10	18.5	0.013
R1/4	G1/4	0913 00 13	11.5	17	22.5	12	22.5	0.025
R3/8	G3/8	0913 00 17	11.5	21	25.5	15	25.5	0.039
R1/2	G1/2	0913 00 21	14	26	30	19	30	0.062
R3/4	G3/4	0913 00 27	16.5	32	34.5	22	35.5	0.100
R1	G1	0913 00 34	18	38.5	40.5	28	40.5	0.167

0922 Equal Stud Elbow, Male Metric Thread

Nickel-plated brass

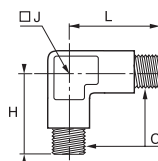

C		H	J	L	Kg
M5x0.8	0922 00 19	11.5	9	11.5	0.010

Nickel-Plated Brass Adaptors

0914 Equal Stud Elbow, Male BSPT Thread

Nickel-plated brass

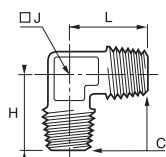

C		H	J	L	Kg
R1/8	0914 00 10	17	10	17	0.010
R1/4	0914 00 13	22.5	12	22.5	0.022
R3/8	0914 00 17	25.5	15	25.5	0.034
R1/2	0914 00 21	30	19	30	0.059
R3/4	0914 00 27	34.5	22	34.5	0.104
R1	0914 00 34	40.5	28	40.5	0.156

0910 Equal Y, Female BSPP Thread

Nickel-plated brass

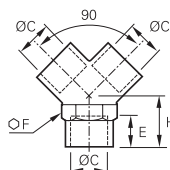

C		E	F	H	Kg
G1/8	0910 00 10	8	13	12	0.018
G1/4	0910 00 13	11	17	14	0.034
G3/8	0910 00 17	11.5	20	16	0.045
G1/2	0910 00 21	14	25	19	0.086

0911 Equal Y, Male BSPT/Female BSPP Thread

Nickel-plated brass

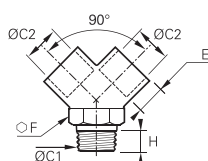

C1	C2		E	F	H	Kg
R1/8	G1/8	0911 00 10	8	13	8	0.022
R1/4	G1/4	0911 00 13	11	17	11	0.039
R3/8	G3/8	0911 00 17	11.5	20	11.5	0.051
R1/2	G1/2	0911 00 21	14	25	14	0.105

0915 Equal Tee, Female BSPP and Metric Thread

Nickel-plated brass

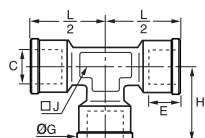

C		E	G	H	J	L/2	Kg
M5x0.8	0915 00 19	5	8	11	9	11	0.010
G1/8	0915 00 10	8	13	18.5	10	18.5	0.022
G1/4	0915 00 13	11	17	22.5	12	22.5	0.042
G3/8	0915 00 17	11.5	21	25.5	15	25.5	0.062
G1/2	0915 00 21	14	26	30	19	30	0.099
G3/4	0915 00 27	16.5	32	35.5	22	35.5	0.145
G1	0915 00 34	18	38.5	40.5	28	40.5	0.233

0923 Equal Stud Branch Tee, Female/Male Metric Thread

Nickel-plated brass

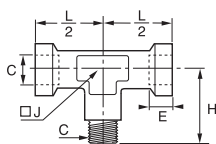

C		E	G	H	J	L/2	Kg
M5x0.8	0923 00 19	4	8	11.5	9	11	0.009

Nickel-Plated Brass Adaptors

0916 Equal Stud Branch Tee, Male BSPT/Female BSPP Thread

Nickel-plated brass

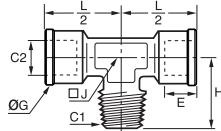

C1	C2		E	G	H	J	L/2	Kg
R1/8	G1/8	0916 00 10	8	13	17	10	18	0.019
R1/4	G1/4	0916 00 13	11	17	22.5	12	22.5	0.038
R3/8	G3/8	0916 00 17	11.5	21	25.5	15	25.5	0.059
R1/2	G1/2	0916 00 21	14	26	30	19	30	0.091
R3/4	G3/4	0916 00 27	16.5	32	34.5	22	35	0.139
R1	G1	0916 00 34	18	38.5	40.5	28	40.5	0.237

0924 Equal Stud Run Tee, Female/Male Metric Thread

Nickel-plated brass

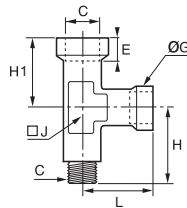

C		E	G	H	H1	J	L	Kg
M5x0.8	0924 00 19	4	8	12	11	9	11	0.009

0917 Equal Stud Run Tee, Female BSPP/Male BSPT Thread

Nickel-plated brass

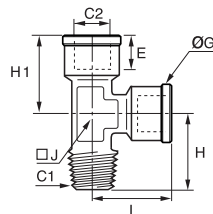

C1	C2		E	G	H	H1	J	L	Kg
R1/8	G1/8	0917 00 10	8	13	17	18.5	10	18.5	0.018
R1/4	G1/4	0917 00 13	11	17	22.5	22.5	12	22.5	0.038
R3/8	G3/8	0917 00 17	11.5	21	25.5	25.5	15	25.5	0.057
R1/2	G1/2	0917 00 21	14	26	30	30	19	30	0.090
R3/4	G3/4	0917 00 27	16.5	32	34.5	35.5	22	35.5	0.137
R1	G1	0917 00 34	18	38.5	40.5	40.5	28	40.5	0.219

0927 Equal Tee, Male BSPT Thread

Nickel-plated brass

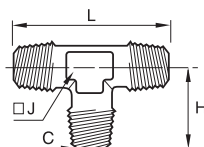

C		H	J	L	Kg
R1/8	0927 00 10	17	10	34	0.013
R1/4	0927 00 13	22.5	12	45	0.032
R3/8	0927 00 17	25.5	15	51	0.056
R1/2	0927 00 21	30	19	60	0.094
R3/4	0927 00 27	34.5	22	69	0.133
R1	0927 00 34	40.5	28	81	0.217

0928 Equal Stud Branch Tee, Male BSPT/ Female BSPP Thread

Nickel-plated brass

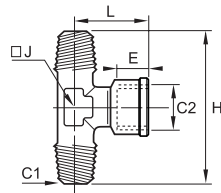

C1	C2		E	H	J	L	Kg
R1/8	G1/8	0928 00 10	8	34	10	18.5	0.016
R1/4	G1/4	0928 00 13	11	45	12	22.5	0.035
R3/8	G3/8	0928 00 17	11.5	51	15	25.5	0.053
R1/2	G1/2	0928 00 21	14	60	19	30	0.087
R3/4	G3/4	0928 00 27	16.5	69	22	35.5	0.236
R1	G1	0928 00 34	18	81	28	40.5	0.225

Nickel-Plated Brass Adaptors

0932 Equal Stud Run Tee, Male BSPT/Female BSPP Thread

Nickel-plated brass

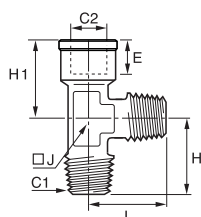

C1	C2		E	H	H1	J	L	Kg
R1/8	G1/8	0932 00 10	8	17	18.5	10	17	0.016
R1/4	G1/4	0932 00 13	11	22.5	22.5	12	22.5	0.035
R3/8	G3/8	0932 00 17	11.5	25.5	25.5	15	25.5	0.055
R1/2	G1/2	0932 00 21	14	30	30	19	30	0.091
R3/4	G3/4	0932 00 27	16.5	34.5	35.5	22	34.5	0.080
R1	G1	0932 00 34	18	40.5	40.5	28	40.5	0.226

0908 Equal Cross, Female BSPP Thread

Nickel-plated brass

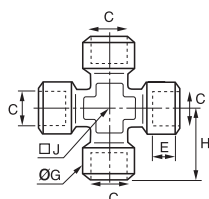

C		E	G	H	J	Kg
G1/8	0908 00 10	8	13	21	10	0.038
G1/4	0908 00 13	11	17	25.5	13	0.075
G3/8	0908 00 17	11.5	21	28	17	0.108
G1/2	0908 00 21	14	26	33.5	21	0.184

0909 Equal Cross, Male BSPT/Female BSPP Thread

Nickel-plated brass

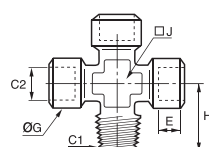

C1	C2		E	G	H	J	Kg
R1/8	G1/8	0909 00 10	8	13	18.5	10	0.034
R1/4	G1/4	0909 00 13	11	17	23.5	13	0.069
R3/8	G3/8	0909 00 17	11.5	21	26	17	0.098
R1/2	G1/2	0909 00 21	14	26	31	21	0.167

KRRS3 Equal Cross, Male BSPT Thread

Nickel-plated brass

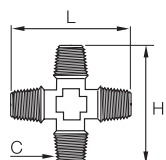

C		H	L	Kg
R1/4	1/4KRRS3BL	47	47	0.046

0903 Reducer, Male/Female BSPP Thread

Nickel-plated brass

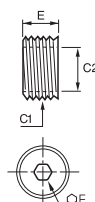

C1	C2		E	F	Kg
G1/4	G1/8	0903 10 13	8	6	0.004
G3/8	G1/4	0903 13 17	9	8	0.007
G1/2	G3/8	0903 17 21	10	10	0.011
G3/4	G1/2	0903 21 27	14	12	0.022
G1	G3/4	0903 27 34	20	17	0.037

Nickel-Plated Brass Adaptors

0904 Reducer, Male BSPT/Female BSPP Thread

Nickel-plated brass

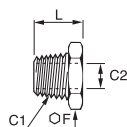

C1	C2		F	L	Kg
R1/4	G1/8	0904 10 13	14	16	0.010
R3/8	G1/8	0904 10 17	17	16.5	0.021
R1/2	G1/8	0904 10 21	22	19.5	0.046
R3/8	G1/4	0904 13 17	17	16.5	0.015
R1/2	G1/4	0904 13 21	22	19.5	0.033
	G3/8	0904 17 21	22	19.5	0.024
R3/4	G3/8	0904 17 27	27	23	0.057
	G1/2	0904 21 27	27	23	0.045
R1	G1/2	0904 21 34	34	27	0.103
	G3/4	0904 27 34	34	27	0.770

0905 Reducer, Male BSPP/Female BSPP and Metric Thread

Nickel-plated brass

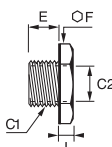

C1	C2		E	F	L	Kg
G1/8	M5x0.8	0905 19 10*	6	14	4.5	0.008
G1/4	G1/8	0905 10 13*	8	17	5	0.011
G3/8	G1/8	0905 10 17*	9	19	5	0.019
G1/2	G1/8	0905 10 21	10	24	5.5	0.034
G3/8	G1/4	0905 13 17	9	19	5	0.013
G1/2	G1/4	0905 13 21	10	24	5.5	0.032
	G3/8	0905 17 21	10	24	5.5	0.021
	G3/8	0905 17 27	11	30	6.5	0.054
G3/4	G1/2	0905 21 27*	11	30	6.5	0.040

*Please contact us for detailed drawings of external thread.

0906 Increaser, Male BSPP and Metric/Female BSPP Thread

Nickel-plated brass

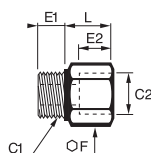

C1	C2		E1	E2	F	L	Kg
M5x0.8	G1/8	0906 10 19	4	8	14	10.5	0.010
	G1/8	0906 00 10	6	8	14	10.5	0.011
G1/8	G1/4	0906 10 13	6	11	17	13.5	0.017
	G3/8	0906 10 17	6	11.5	22	14.5	0.030
	G1/4	0906 00 13	8	11	17	13.5	0.019
G1/4	G3/8	0906 13 17	8	11.5	22	14.5	0.032
	G1/2	0906 13 21	8	14	24	18	0.037
	G3/8	0906 00 17	9	11.5	22	14.5	0.034
G3/8	G1/2	0906 17 21	9	14	24	18	0.038
G1/2	G1/2	0906 00 21	10	14	26	20	0.053

0933 Increaser, Male BSPT/Female BSPP Thread

Nickel-plated brass

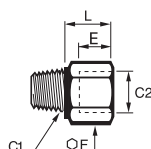

C1	C2		F	L	Kg
R1/8	G1/8	0933 00 10	14	10	0.011
R1/4	G1/4	0933 00 13	17	13.5	0.021
R3/8	G3/8	0933 00 17	22	14.5	0.037
R1/2	G1/2	0933 00 21	26	18	0.059
R1/8	G1/4	0933 10 13	17	13.5	0.018
	G3/8	0933 10 17	22	14.5	0.029
	G3/8	0933 13 17	22	14.5	0.034
R1/4	G1/2	0933 13 21	24	18	0.045
R3/8	G1/2	0933 17 21	24	18	0.030
R1/2	G3/4	0933 21 27	32	23.5	0.080

Nickel-Plated Brass Adaptors

0907 Equal Extended Adaptor, Male/Female BSPP Thread

Nickel-plated brass

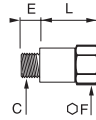

C		E	F	L	Kg
G1/8	0907 00 10	6	14	16	0.015
	0907 00 10 01	6	14	36	0.030
G1/4	0907 00 13	8	17	27	0.032
	0907 00 13 01	8	17	43	0.047

0920 Bulkhead Connector, Female BSPP and Metric Thread

Nickel-plated brass

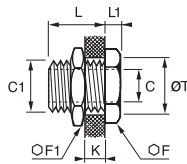

C	C1		F	F1	K _{max}	L	L1	ØT	Kg
M5x0.8	M10x1	0920 00 19	14	14	7	10.5	3.5	10.5	0.012
G1/8	M16x1.5	0920 00 10	19	22	10	14	4	16.5	0.029
G1/4	M20x1.5	0920 00 13	24	27	16	21	4	20.5	0.056
G3/8	M26x1.5	0920 00 17	30	32	15	21	5	26.5	0.094
G1/2	M28x1.5	0920 00 21	32	36	21	27	6	28.5	0.115

0900 Equal and Unequal Adaptor, Male BSPT Thread

Nickel-plated brass

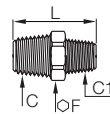

C1	C2		F	L	Kg
R1/8	R1/8	0900 00 10	12	20.5	0.009
	R1/4	0900 10 13	14	24	0.015
	R3/8	0900 10 17	17	24.5	0.020
R1/4	R1/4	0900 00 13	14	27	0.019
	R3/8	0900 13 17	17	27.5	0.025
	R1/2	0900 13 21	22	30.5	0.045
R3/8	R3/8	0900 00 17	17	28	0.025
	R1/2	0900 17 21	22	31	0.045
	R1/2	0900 00 21	22	33.5	0.044
R1/2	R3/4	0900 21 27	27	37	0.083
	R3/4	0900 00 27	27	39.5	0.079
	R1	0900 27 34	34	42.5	0.143
R1	R1	0900 00 34	34	45.5	0.152

0901 Equal and Unequal Adaptor, Male BSPP and Metric Thread

Nickel-plated brass

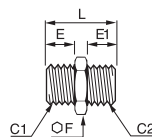

C1	C2		E	E1	F	L	Kg
M5x0.8	M5x0.8	0901 00 19	4	4	8	11.5	0.002
	G1/8	0901 19 10	4	6	14	14.5	0.008
	G1/8	0901 00 10	6	6	14	16.5	0.009
G1/8	G1/4	0901 10 13	6	8	17	19	0.016
	G3/8	0901 10 17	6	9	19	20	0.020
	G1/4	0901 00 13	8	8	17	21	0.019
G1/4	G3/8	0901 13 17	8	9	19	22	0.023
	G1/2	0901 13 21	8	10	24	23.5	0.036
	G3/8	0901 00 17	9	9	19	23	0.025
G3/8	G1/2	0901 17 21	9	10	24	24.5	0.038
	G1/2	0901 00 21	10	10	24	25.5	0.039
	G3/4	0901 21 27	10	12	30	27.5	0.062

Nickel-Plated Brass Adaptors

0192 Unequal Straight Adaptor, Male BSPT/BSPP Thread

Nickel-plated brass

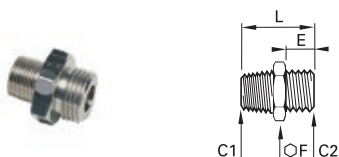

C1	C2		E	F	L	Kg
R1/8	G1/4	0192 10 13	9.5	17	23.5	0.019
R1/4	G1/4	0192 13 13	9.5	17	27.5	0.024
	G1/2	0192 13 21	11	27	31.5	0.068
R3/8	G1/4	0192 17 13	9.5	17	28	0.025
	G1/2	0192 17 21	11	27	31.5	0.060
R1/2	G1/2	0192 21 21	11	27	34	0.061

0902 Equal and Unequal Adaptor, Female BSPP and Metric Thread

Nickel-plated brass

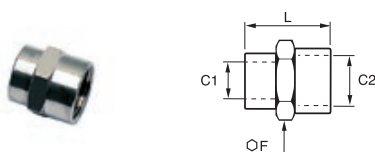

C1	C2		F	L	Kg
M5x0.8	M5x0.8	0902 00 19	8	11	0.003
	G1/8	0902 19 10	14	13.5	0.009
	G1/8	0902 00 10	14	15	0.010
G1/8	G1/4	0902 10 13	17	19	0.017
	G3/8	0902 10 17	22	20	0.027
	G1/2	0902 10 21	24	20	0.015
	G1/4	0902 00 13	17	22	0.020
G1/4	G3/8	0902 13 17	22	22.5	0.030
	G1/2	0902 13 21	26	24	0.033
G3/8	G3/8	0902 00 17	22	23	0.033
	G1/2	0902 17 21	24	26	0.036
	G1/2	0902 00 21	26	28	0.048
G1/2	G3/4	0902 21 27	32	30	0.077
	G1	0902 21 34	40	39	0.145
G3/4	G3/4	0902 00 27	32	32	0.076
	G1	0902 27 34	40	41	0.146

0191 Tailpiece Adaptor for Rubber Hose, Male BSPP Thread

Nickel-plated brass

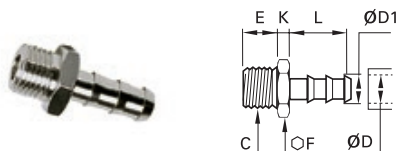

ØD	ØD1	C		E	F	K	L	Kg
4	6	G1/4	0191 04 13	9.5	17	5	22.5	0.019
		G1/4	0191 07 13	9.5	17	5	22.5	0.022
		G1/2	0191 07 21	11	27	7	29.5	0.056
		G1/4	0191 10 13	9.5	17	5	22.5	0.020
		G1/2	0191 10 21	11	27	7	29.5	0.060
		G1/4	0191 13 13	9.5	17	5	22.5	0.022
		G1/2	0191 13 21	11	27	7	29.5	0.059
		G1/2	0191 16 21	11	27	7	36.5	0.068

0931 Tailpiece Adaptor for Rubber Hose, Male BSPP Thread

Nickel-plated brass

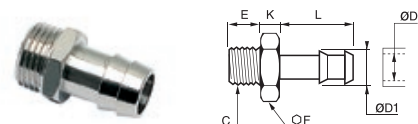

ØD	ØD1	C		E	F	K	L	Kg
4	4.5	M5x0.8	0931 04 19	4	8	4	15	0.003
		G1/8	0931 06 10	6	12	4.5	19	0.009
		G1/4	0931 06 13	8	14	5	19	0.013
		G1/8	0931 07 10	6	12	4	19	0.009
		G1/4	0931 07 13	8	14	5	19	0.013
		G3/8	0931 07 17	9	19	5	19	0.022
		G1/8	0931 08 10	6	12	4	19	0.009
		G1/4	0931 08 13	8	14	5	19	0.014
		G3/8	0931 08 17	9	19	5	19	0.022
		G1/4	0931 10 13	8	14	5	19	0.016
		G3/8	0931 10 17	9	19	5	19	0.023
		G1/2	0931 10 21	10	22	6	20	0.031
		G3/8	0931 15 17	9	19	6	24	0.030
		G1/2	0931 15 21	10	22	6	24	0.038
		G1/2	0931 18 21	10	22	6	24	0.040

Nickel-Plated Brass Adaptors

0934

Tailpiece Adaptor for Polymer Tubing, Male BSPT Thread

Nickel-plated brass

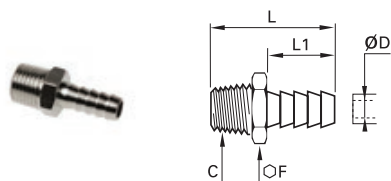

ØD	C		F	L	L1	Kg
6	R1/8	0934 06 10	12	31.5	19	0.009
	R1/4	0934 06 13	14	35	19	0.014
7	R1/8	0934 07 10	12	31.5	19	0.009
	R1/4	0934 07 13	14	35	19	0.014
8	R1/8	0934 08 10	12	31.5	19	0.010
	R1/4	0934 08 13	14	35	19	0.015
9	R1/8	0934 09 10	12	31.5	19	0.012
	R1/4	0934 09 13	14	35	19	0.015
10	R3/8	0934 09 17	17	35.5	19	0.021
	R1/2	0934 09 21	22	38.5	19	0.032
11	R1/8	0934 10 10	12	32.5	20	0.010
	R1/4	0934 10 13	14	36	20	0.015
12	R3/8	0934 10 17	17	36.5	20	0.022
	R1/2	0934 10 21	22	39.5	20	0.033
13	R1/4	0934 12 13	14	36	20	0.019
	R3/8	0934 12 17	17	36.5	20	0.021
14	R1/2	0934 12 21	22	39.5	20	0.033
	R3/8	0934 14 17	17	38.5	22	0.023
15	R1/2	0934 14 21	22	41.5	22	0.036
	R3/8	0934 16 17	17	38.5	22	0.026
16	R1/2	0934 16 21	22	41.5	22	0.038
	R3/4	0934 16 27	27	45	22	0.062
17	R3/8	0934 17 17	18	40.5	24	0.030
	R1/2	0934 17 21	22	43.5	24	0.043
18	R3/8	0934 18 17	19	40.5	24	0.031
	R1/2	0934 18 21	22	43.5	24	0.043
19	R3/4	0934 18 27	27	47	24	0.062
	R3/8	0934 20 17	22	41	24	0.038
20	R1/2	0934 20 21	22	43.5	24	0.046

0935

Tailpiece Adaptor for Polymer Tubing, Male BSPP Thread

Nickel-plated brass

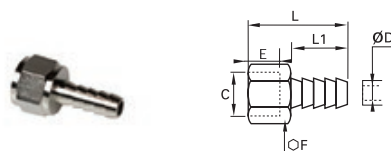

ØD	C		E	F	L	L1	Kg
6	G1/8	0935 06 10	8	12	28.5	19	0.007
7	G1/8	0935 07 10	8	12	28.5	19	0.012
8	G1/4	0935 08 13	11	15	31.5	19	0.019
9	G1/4	0935 09 13	11	15	31.5	19	0.020
	G3/8	0935 09 17	11.5	19	32	19	0.025
10	G3/8	0935 10 17	11.5	19	33	20	0.025
12	G3/8	0935 12 17	11.5	19	33	20	0.027
	G1/2	0935 12 21	14.5	24	36	20	0.040

Stainless Steel Adaptors

1844 Equal Stud Elbow, Male BSPT/Female BSPP Thread

Stainless steel 316L

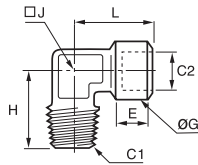

C1	C2		E	G	H	J	L	Kg
R1/8	G1/8	1844 10 10	7.5	15	20.5	10	22.5	0.022
R1/4	G1/4	1844 13 13	12	18.5	27.5	12	26.5	0.047
R3/8	G3/8	1844 17 17	12	23.5	28	14	30	0.069
R1/2	G1/2	1844 21 21	15	28	38	18	38	0.116
R3/4	G3/4	1844 27 27	16.5	33	41	22	44.5	0.158
R1	G1	1844 34 34	19	40	48	32	50	0.312

1843 Equal Elbow, Female BSPP Thread

Stainless steel 316L

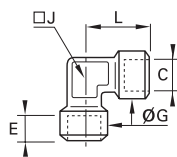

C		E	G	J	L	Kg
G1/8	1843 10 10	7.5	17.5	12	22.5	0.042
G1/4	1843 13 13	11	18.5	15	26.5	0.053
G3/8	1843 17 17	11.5	23.5	18	29	0.079
G1/2	1843 21 21	15	28	23	38	0.157
G3/4	1843 27 27	16.5	33	22	43.5	0.209
G1	1843 34 34	19	40	32	52	0.444

1845 Equal Tee, Female BSPP Thread

Stainless steel 316L

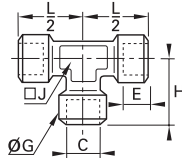

C		E	G	H	J	L/2	Kg
G1/8	1845 10 10	7.5	17.5	22.5	12	22.5	0.058
G1/4	1845 13 13	11	18.5	26.5	15	26.5	0.076
G3/8	1845 17 17	11.5	23.5	29	18	29	0.102
G1/2	1845 21 21	15	28	38	23	38	0.218
G3/4	1845 27 27	16.5	33	43.5	22	43.5	0.301
G1	1845 34 34	19	40	50	32	50	0.446

1817 Equal Bulkhead Adaptor, Female BSPP Thread

Stainless steel 316L

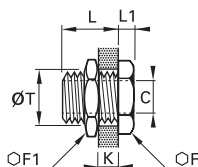

C		F	F1	K _{max}	L	L1	ØT _{min}	Kg
G1/8	1817 00 10	19	22	9	14	4	16.5	0.031
G1/4	1817 00 13	24	27	15	21	4	20.5	0.053
G3/8	1817 00 17	30	32	14	21	5	26.5	0.090
G1/2	1817 00 21	32	36	20	27	6	28.5	0.108
G3/4	1817 00 27	41	41	22.5	30	6	34.5	0.152
G1	1817 00 34	46	50	24.5	34	8	42.5	0.251

1871 Equal Bulkhead Adaptor, Female NPT Thread

Stainless steel 316L

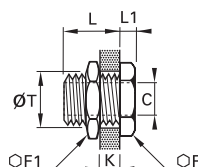

C		F	F1	K _{max}	L	L1	ØT _{min}	Kg
NPT1/8	1871 00 11	19	22	9	14	5	16.5	0.031
NPT1/4	1871 00 14	24	22	9	14	5	16.5	0.060
NPT3/8	1871 00 18	30	32	18	23	5	26.5	0.096
NPT1/2	1871 00 22	32	36	22	29	6	28.5	0.119

Stainless Steel Adaptors

1855 Equal Connector, Female BSPP Thread

Stainless steel 316L

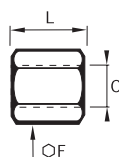

C		F	L	Kg
G1/8	1855 10 10	14	17	0.013
G1/4	1855 13 13	17	24	0.023
G3/8	1855 17 17	22	25	0.042
G1/2	1855 21 21	27	32	0.079
G3/4	1855 27 27	14	35	0.102
G1	1855 34 34	41	40	0.202

1870 Equal Connector, Female NPT Thread

Stainless steel 316L

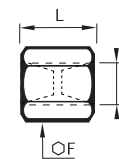

C		F	L	Kg
NPT1/8	1870 11 11	14	19	0.015
NPT1/4	1870 14 14	17	28	0.029
NPT3/8	1870 18 18	22	28	0.050
NPT1/2	1870 22 22	27	35	0.092

1862 Reducer Connector, Female BSPP Thread

Stainless steel 316L

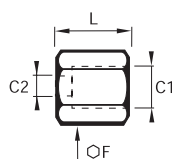

C1	C2		F	L	Kg
G1/4	G1/8	1862 13 10	17	20.5	0.024
G3/8	G1/8	1862 17 10	22	21	0.043
	G1/4	1862 17 13	22	24.5	0.048
G1/2	G1/4	1862 21 13	27	28.5	0.086
	G3/8	1862 21 17	27	29	0.081
G3/4	G1/2	1862 27 21	32	39.5	0.148
G1	G3/4	1862 34 27	41	45	0.281

1864 Adaptor, Male NPT/Female BSPP Thread

Stainless steel 316L

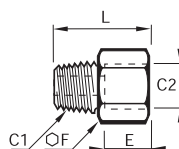

C1	C2		E	F	L	Kg
NPT1/8	G1/8	1864 11 10	7.5	14	21.5	0.015
NPT1/4	G1/4	1864 14 13	11	17	30	0.028
NPT3/8	G3/8	1864 18 17	11.5	22	31	0.043
NPT1/2	G1/2	1864 22 21	15	27	39.5	0.081

1867 Adaptor, Male BSPT/Female NPT Thread

Stainless steel 316L

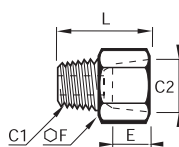

C1	C2		E	F	L	Kg
R1/8	NPT1/8	1867 10 11	8	14	21	0.015
R1/4	NPT1/4	1867 13 14	11.5	17	28.5	0.028
R3/8	NPT3/8	1867 17 18	12	22	29.5	0.044
R1/2	NPT1/2	1867 21 22	15.5	27	37.5	0.083

Stainless Steel Adaptors

1863 Reducer, Male BSPT/Female BSPP Thread

Stainless steel 316L

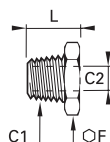

C1	C2		F	L	Kg
R1/4	G1/8	1863 13 10	14	16	0.008
	G1/8	1863 17 10	17	16.5	0.019
R3/8	G1/4	1863 17 13	17	16.5	0.011
	G1/4	1863 21 13	22	21	0.035
	G3/8	1863 21 17	22	21	0.023
R1/2	G1/2	1863 27 21	27	25.5	0.045
R3/4	G1/2	1863 27 21	27	25.5	0.045
R1	G3/4	1863 34 27	36	28.5	0.083

1872 Reducer, Male/Female NPT Thread

Stainless steel 316L

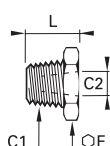

C1	C2		F	L	Kg
NPT1/4	NPT1/8	1872 14 11	14	16	0.010
	NPT1/8	1872 18 11	19	16.5	0.023
NPT3/8	NPT1/4	1872 18 14	19	16.5	0.016
	NPT1/4	1872 22 14	22	21	0.039
NPT1/2	NPT3/8	1872 22 18	22	21	0.027

1861 Increaser, Male BSPT/Female BSPP Thread

Stainless steel 316L

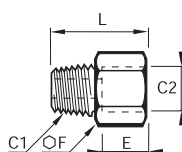

C1	C2		E	F	L	Kg
R1/8	G1/4	1861 10 13	11	17	24	0.022
	G3/8	1861 10 17	11.5	22	25	0.038
	G3/8	1861 13 17	11.5	22	28.5	0.042
R1/4	G1/2	1861 13 21	15	27	32.5	0.069
R3/8	G1/2	1861 17 21	15	27	33	0.070
R1/2	G3/4	1861 21 27	16.5	32	38	0.093
R3/4	G1	1861 27 34	19	41	43.5	0.182

1873 Increaser, Male/Female NPT Thread

Stainless steel 316L

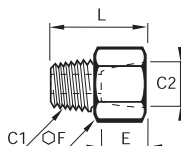

C1	C2		E	F	L	Kg
NPT1/8	NPT1/4	1873 11 14	14	17	25	0.024
	NPT3/8	1873 11 18	14	22	25	0.039
	NPT3/8	1873 14 18	14	22	28.5	0.042
NPT1/4	NPT1/2	1873 14 22	17.5	27	31	0.064
NPT3/8	NPT1/2	1873 18 22	17.5	27	31.5	0.064

1821 Equal and Unequal Adaptor, Male BSPT Thread

Stainless steel 316L

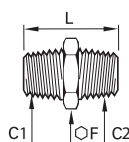

C1	C2		F	L	Kg
R1/8	R1/8	1821 10 10	12	19	0.009
	R1/8	1821 13 10	14	23.5	0.015
R1/4	R1/4	1821 13 13	14	27	0.019
	R1/4	1821 17 13	17	27.5	0.024
R3/8	R3/8	1821 17 17	17	28	0.023
	R3/8	1821 21 17	22	32.5	0.042
R1/2	R1/2	1821 21 21	22	36	0.047
	R1/2	1821 27 21	27	41	0.079
R3/4	R3/4	1821 27 27	27	42	0.088
	R3/4	1821 34 27	36	46	0.142
R1	R1	1821 34 34	36	48	0.146

Stainless Steel Adaptors

1821 Equal Adaptor, Male NPT Thread

Stainless steel 316L

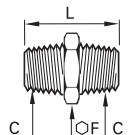

C		F	L	Kg
NPT1/8	1821 11 11	12	23	0.011
NPT1/4	1821 14 14	14	32	0.023
NPT3/8	1821 18 18	19	33	0.031
NPT1/2	1821 22 22	22	42	0.056
NPT3/4	1821 28 28	27	40	0.081
NPT1	1821 35 35	36	46	0.136

1823 Tailpipe Adaptor for Rubber Hose, Male BSPT Thread

Stainless steel 316L

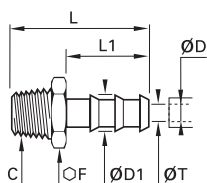

ØD	ØD1	C		F	L	L1	ØT	Kg
7	9	R1/8	1823 07 10	10	34	22.5	5	0.009
		R1/4	1823 07 13	14	38.5	22.5	6	0.017
10	12.2	R1/4	1823 10 13	14	38.5	22.5	7	0.018
		R3/8	1823 10 17	17	39	22.5	9.5	0.021
13	15	R3/8	1823 13 17	17	46	29.5	11	0.025
16	18.5	R1/2	1823 16 21	22	59	38	14	0.049

1823 Tailpipe Adaptor for Rubber Hose, Male NPT Thread

Stainless steel 316L

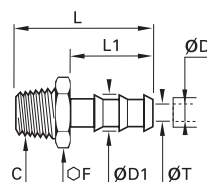



ØD	ØD1	C		F	L	L1	ØT	Kg
1/4	8.3	NPT1/8	1823 56 11	12	34	22.5	5.3	0.010
		NPT1/4	1823 56 14	14	38.5	22.5	5.3	0.016
3/8	11.7	NPT1/4	1823 60 14	14	38.5	22.5	8.5	0.018
		NPT3/8	1823 60 18	19	39	22.5	8.5	0.026

Brass Manifolds

0135

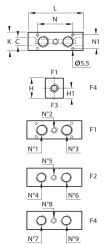
Manifold Block, Female BSPP Thread

Brass		C		H	H1	K	L	N	Kg
		G1/4	0135 06 13	30	13	25	70	37	0.335
			0135 09 13	30	13	25	87	54	0.409
		G1/2	0135 06 21	40	16	35	86	45	0.714
			0135 09 21	40	16	35	109	68	0.899
		G3/4	0135 10 27	45	21	40	122	78	1.232
		This product is designed to distribute in several directions. The number of ports can be increased by using tee pieces, cross pieces or double banjo couplings.							

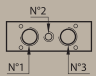
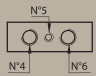
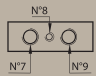
Installation Options												
	<div>F1</div>  <div>F1</div>				<div>F2</div>  <div>F2</div>				<div>F4</div>  <div>F4</div>			
	Number of Outlets	N°1	N°2	N°3	Number of Outlets	N°4	N°5	N°6	Number of Outlets	N°7	N°8	N°9
0135 06 13	1		G1/4		2	G1/8		G1/8	2	G1/8		G1/8
0135 09 13	2	G1/4		G1/4	3	G1/8	G1/8	G1/8	3	G1/8	G1/8	G1/8
0135 06 21	1		G1/2		2	G1/4		G1/4	2	G1/8		G1/8
0135 09 21	2	G1/2		G1/2	3	G1/4	G1/4	G1/4	3	G1/8	G1/8	G1/8
0135 10 27	3	G1/2	G1/8	G1/2	3	G1/8	G1/8	G1/8	3	G1/4	G1/8	G1/4

Anodised Aluminium Manifolds

3310 In-Line Manifold

Treated aluminium, NBR

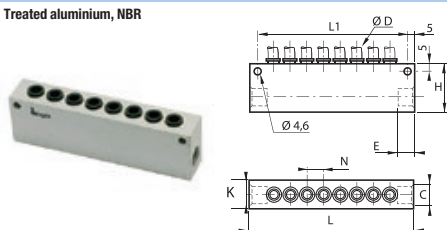

ØD	C		Number of Outlets	E	H	K	L	L1	N	Kg
4	G1/4	3310 04 13	8	10	33	20	114	104	11.5	0.164
6	G1/4	3310 06 13	8	10	33	20	114	104	12.5	0.170
8	G3/8	3310 08 17	6	12	33	20	114	104	15	0.148
10	G1/2	3310 10 21	6	16	48	25	145.5	135.5	17	0.334
12	G1/2	3310 12 21	6	16	45	25	158	148	20.5	0.370

3311 Manifold, Female BSPP and Metric Thread

Treated aluminium

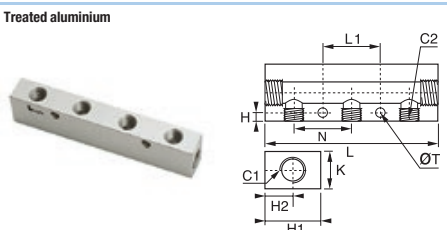

C1	C2		Number of Outlets	H	H1	H2	K	L	L1	N	ØT	Kg
G1/8	M5x0.8	3311 19 10 07	7	3.5	20	8.5	15	95	80	11	4.4	0.067
		3311 10 13 02	2	4.5	30	15	20	61	50	30	5	0.074
		3311 10 13 03	3	4.5	30	15	20	91	30	30	5	0.121
G1/4	G1/8	3311 10 13 04	4	4.5	30	15	20	121	60	30	5	0.165
		3311 10 13 05	5	4.5	30	15	20	151	90	30	5	0.209
		3311 10 13 06	6	4.5	30	15	20	181	120	30	5	0.244
		3311 13 17 02	2	5.5	30	11	20	74	61	36	6.5	0.076
G3/8	G1/4	3311 13 17 03	3	6	30	11	20	110	36	36	6.5	0.121
		3311 13 17 04	4	6	30	11	20	146	72	36	6.5	0.144
		3311 13 17 05	5	6	30	11	20	182	108	36	6.5	0.212
		3311 13 17 06	6	6	30	11	20	218	144	36	6.5	0.265

3312 Cross Manifold, Female BSPP and Metric Thread

Treated aluminium

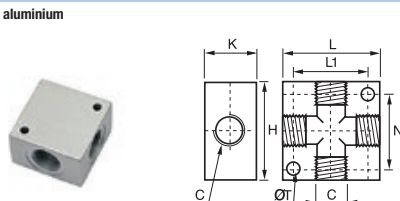

C			H	K	L	L1	N	ØT	Kg
M5x0.8	3312 00 19		20	10	20	12	12	4.5	0.010
G1/8	3312 00 10		30	16	30	23	22	4.5	0.029
G1/4	3312 00 13		40	20	40	30	27	5.5	0.061
G3/8	3312 00 17		50	25	50	38	39	6.5	0.125
G1/2	3312 00 21		50	25	50	38	39	6.5	0.101

3313 Double Manifold, Female BSPP Thread

Treated aluminium

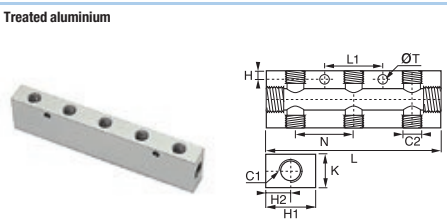

C1	C2		Number of Outlets	H	H1	H2	K	L	L1	N	ØT	Kg
G1/4	G1/8	3313 10 13 02	2x2	4.5	30	15	20	61	50	30	5	0.075
		3313 10 13 03	2x3	4.5	30	15	20	91	30	30	5	0.115
		3313 10 13 04	2x4	4.5	30	15	20	121	60	30	5	0.151
		3313 10 13 05	2x5	4.5	30	15	20	151	90	30	5	0.194
G3/8	G1/4	3313 13 17 02	2x2	6	40	20	20	74	61	36	6.5	0.109
		3313 13 17 03	2x3	6	40	20	20	110	36	36	6.5	0.179
		3313 13 17 04	2x4	6	40	20	20	146	72	36	6.5	0.238
		3313 13 17 05	2x5	6	40	20	20	182	108	36	6.5	0.286
G1/2	G1/4	3313 13 21 03	2x3	6	40	20	28	116	36	36	6.5	0.233
		3313 13 21 04	2x4	6	40	20	28	152	72	36	6.5	0.295
		3313 13 21 05	2x5	6	40	20	28	188	108	36	6.5	0.374

Anodised Aluminium Manifolds

3301 Modular Manifold

Treated aluminium, NBR

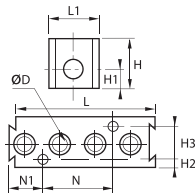

ØD		Number of Outlets	H	H1	H2	H3	L	L1	N	N1	Kg
4	3301 04 00	8	25	10	4.5	16	73.5	25	35	17	0.108
6	3301 06 00	4	25	10	4.5	16	73.5	25	35	17	0.110

Fixing with screw M3x20

3301 Manifold, Female BSPP Thread

Treated aluminium, NBR

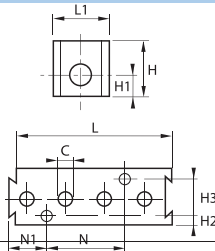

C		Number of Outlets	H	H1	H2	H3	L	L1	N	N1	Kg
G1/8	3301 07 10	4	25	10	4.5	16	73.5	25	35	17	0.097

Fixing with screw M3x20

NPT available on request

3302 Single Manifold, Female BSPP Thread

Treated aluminium, NBR

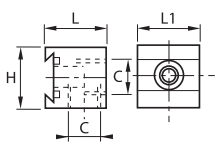

C		H	L	L1	Kg
G1/4	3302 01 13 01	25	24.5	25	0.031

3302 01 13: side entry thread

3302 01 13 01: rear entry thread

NPT available on request

3302 Double Manifold, Female BSPP Thread

Treated aluminium, NBR

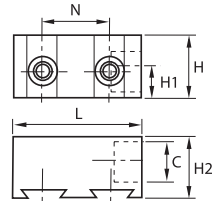

C		H	H1	H2	L	N	Kg
G3/8	3302 02 17	25	12.5	24.5	51	26	0.061

Side entry thread

NPT available on request

3302 Triple Manifold, Female BSPP Thread

Treated aluminium, NBR

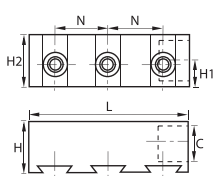



C		H	H1	H2	L	N	Kg
G3/8	3302 03 17	25	12.5	25	77	26	0.087

Lateral supply

NPT available on request

Anodised Aluminium Manifolds

3303 End Plate for Manifold

Treated aluminium											
					H	H1	L	Kg			
					3303 00 01			9.5	3.5	25	0.014

3303 Angled Fixing Plate

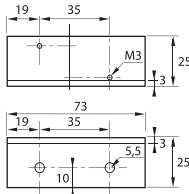
Treated aluminium		Kg
		3303 00 02
		0.029

Brass Plugs

0205 Internal Hexagon Head Plug, Male BSPT Thread

Brass

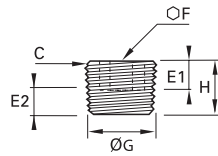

C		E1	E2 min	E2 max	F	G	H	Kg
R1/8	0205 10 00	6	3.1	4.9	5	9.7	8	0.003
R1/4	0205 13 00	8	4.7	7.3	6	13.2	10	0.007
R3/8	0205 17 00	8	5.1	7.7	8	16.7	11	0.013
R1/2	0205 21 00	8	6.4	10	10	21	13	0.026
R3/4	0205 27 00	11	7.7	11.3	14	26.4	17	0.054
R1	0205 34 00	13	8.1	12.7	17	33.2	19	0.094
R1 1/4	0205 42 00	14	10.4	15	22	41.9	22	0.178
R1 1/2	0205 49 00	14	10.4	15	24	47.8	22	0.246
R2	0205 48 00	16	13.6	18.2	30	59.6	25	0.431

For BSPT plug from 1/2" - 1 1/2" inclusive:

Conforms to DIN 906

Thread: EN 10226-1

0205 Internal Hexagon Head Plug, Male NPT Thread

Brass

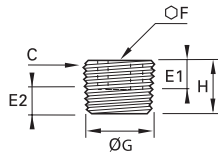

C		E1	E2 min	E2 max	F	G	H	Kg
NPT1/8	0205 11 00	6	3.2	5	5	10.2	8	0.003
NPT1/4	0205 14 00	8	4.4	7.2	6	13.6	10	0.008
NPT3/8	0205 18 00	8	4.7	7.5	8	17	11	0.014
NPT1/2	0205 22 00	8	6.3	9.9	10	21.2	13	0.026
NPT3/4	0205 28 00	11	6.8	10.4	14	26.6	17	0.052
NPT1	0205 35 00	13	8	12.4	17	33.2	19	0.091

HHP Internal Hexagon Head Plug, Male NPTF Thread, Heavy Series

Brass

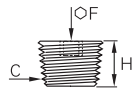

C		F*	H	Kg
NPTF1/4	1/4 HHP-B	1/4	12	0.009

*Inch dimensions **Max. working pressure: 260 bar

219P Hexagon Head Plug, Male NPTF Thread

Brass

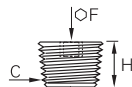

C		F*	H	Kg
NPTF1/8	219P-2	3/16	8	0.004
NPTF1/4	219P-4	1/4	12	0.009
NPTF3/8	219P-6	5/16	12	0.015

*Inch dimensions

0209 Square Head Plug, Male BSPT Thread

Brass

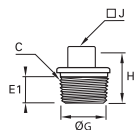

C		E1	E2 min	E2 max	G	H	J	Kg
R1/8	0209 10 00	6	3.1	4.9	9.7	16	6	0.007
R1/4	0209 13 00	8	4.7	7.3	13.2	18	8	0.014
R3/8	0209 17 00	10	5.1	7.7	16.7	20	10	0.025
R1/2	0209 21 00	11	6.4	10	21	22	13	0.047
R3/4	0209 27 00	15	7.7	11.3	26.4	28	17	0.097
R1	0209 34 00	18	8.1	12.7	33.2	32	19	0.169

Conforms to DIN 906

Thread: EN 10226-1

Brass Plugs

0220 Hex Head Plug, Male BSPP and Metric Thread

Brass, technical polymer

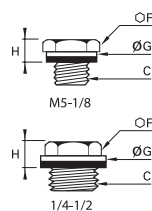

C		F	G	H1	Kg
M5x0.8	0220 19 00	8	8	5	0.002
G1/8	0220 10 00	14	14	7.5	0.011
G1/4	0220 13 00	17	17	7.5	0.019
G3/8	0220 17 00	17	22	8.5	0.024
G1/2	0220 21 00	22	27	10	0.041

Thread with pre-assembled sealing washer

M5: with screwdriver slot for tightening

Maximum allowable working pressure = 20 bar

Part number with suffix 99, maximum allowable working pressure = 250 bar, example: 0220 19 00 99

Conforms to BNA 229 (with the exception of M5 model), BSPP thread, ISO ISO 228-1,

Parallel metric thread, ISO NFE 03-054

0200 Hex Head Plug, Male BSPP and Metric Thread

Brass

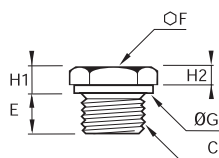

C		E	F	G	H1	H2	Kg
M6x1	0200 52 00	6	10	10	4	3.5	0.004
M8x1.25	0200 57 00	7	13	13	4	3.5	0.007
M10x1	0200 60 00	8	14	14	5	4.5	0.011
M12x1	0200 65 00	9	17	17	5	4.5	0.018
M12x1.25	0200 66 00	9	17	17	5	4.5	0.018
G1/8	0200 10 00	7	14	13.7	5.5	4	0.011
G1/4	0200 13 00	8.5	17	16.7	5.5	4	0.019

Brass Plugs

0201

Hex Head Plug with Collar, Male BSPP and Metric Thread

Brass

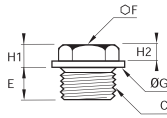

C		E	F	G	H1	H2	Kg
M16x1.5	0201 75 00	10	17	22	6.5	5	0.025
M18x1.5	0201 78 00	10	17	24	7	5	0.027
M20x1.5	0201 80 00	10	17	26	7.5	5	0.031
M22x1.5	0201 82 00	10	22	30	7.5	5	0.044
M24x1.5	0201 83 00	10	22	32	7.5	5	0.048
M24x2	0201 92 00	10	22	32	7.5	5	0.046
M30x2	0201 88 00	11	27	38	8.5	6	0.075
G3/8	0201 17 00	10	17	21.7	6.5	4.5	0.024
G1/2	0201 21 00	10	22	26.7	7.5	5	0.041
G3/4	0201 27 00	11	22	31.7	8.5	6	0.058
G1	0201 34 00	11	27	39.7	8.5	6	0.086
G1 1/4	0201 42 00	12	30	49.7	10	7	0.142

HP3

Hexagon Head Plug, Male BSPT Thread

Brass

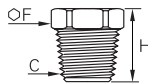

C		F	H	Kg
R1/8	1/8HP3B	10	12	0.007
R1/4	1/4HP3B	14	16	0.018
R3/8	3/8HP3B	17	17	0.029
R1/2	1/2HP3B	22	21	0.059
R3/4	3/4HP3B	27	24	0.110
R1	1HP3B	36	27	0.196

218P

Hexagon Head Plug, Male NPTF Thread, Heavy Series

Brass

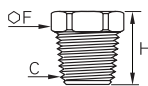

C		F	H	Kg
NPTF1/8	218P-2	7/16	14	0.008
NPTF1/4	218P-4	9/16	19	0.020
NPTF3/8	218P-6	11/16	20	0.033
NPTF1/2	218P-8	7/8	25	0.058

*Inch dimensions

0202

Internal Hexagon Head Plug with Collar, Male Metric Thread

Brass

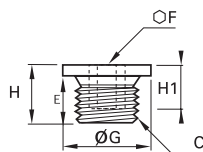

C		E	F	G	H	H1	Kg
M12x1	0202 65 00	9	6	17	11	8	0.009
M12x1.25	0202 66 00	9	6	17	11	8	0.009
M14x1.5	0202 71 00	10	6	19	13	10	0.015
M16x1.5	0202 75 00	10	8	22	13	10	0.019
M18x1.5	0202 78 00	10	10	24	13	10	0.022
M20x1.5	0202 80 00	10	12	26	13	10	0.025
M22x1.5	0202 82 00	10	12	30	13	10	0.034
M27x2	0202 86 00	11	17	35	15	11	0.052
M30x2	0202 88 00	11	19	38	15	11	0.062

Parallel metric threads, ISO standard NFE 03-054

Nickel-Plated Brass Plugs

0936 Internal Hexagon Head Plug, Male BSPT Thread

Nickel-plated brass

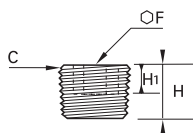

C		F	H	Kg
R1/8	0936 00 10	5	8	0.003
R1/4	0936 00 13	6	10	0.007
R3/8	0936 00 17	8	11	0.013
R1/2	0936 00 21	10	13	0.026

0919 Internal Hexagon Head Plug, Male BSPP and Metric Thread

Nickel-plated brass

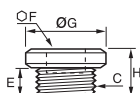

C		E	F	G	H	Kg
M5x0.8	0919 00 19	4	2.5	8	6.5	0.001
G1/8	0919 00 10	6	5	15	9.5	0.007
G1/4	0919 00 13	8	6	18	11.5	0.013
G3/8	0919 00 17	9	8	21	13	0.021
G1/2	0919 00 21	10	10	25	14.5	0.035
G3/4	0919 00 27	11	14	31	15.5	0.049
G1	0919 00 34	13	17	38	17.5	0.072

0938 External Hexagon Head Plug, Male BSPP Thread

Nickel-plated brass



C		E	F	H	Kg
M5x0.8	0938 00 19	4	8	7	0.002
G1/8	0938 00 10	6	14	10	0.007
G1/4	0938 00 13	8	17	12.5	0.014
G3/8	0938 00 17	9	19	13.5	0.020
G1/2	0938 00 21	10	24	15.5	0.031
G3/4	0938 00 27	11	30	16.5	0.050
G1	0938 00 34	13	38	19	0.100

FN4 Hexagon Head End Plug, Male BSPP Thread

Nickel-plated brass

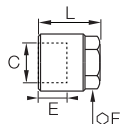

C		E	F	L	Kg
G1/8	1/8FN4BL	7.5	12	11	0.005
G1/4	1/4FN4BL	11	14	19	0.015
G1/2	1/2FN4BL	14	19	22	0.040

Steel Plugs

0206 Internal Hexagon Head Plug, Male BSPT Thread

Steel

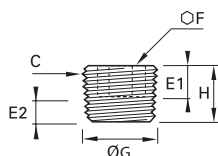

C		E1	E2 min	E2 max	F	G	H	Kg
R1/8	0206 10 00	6	3.1	4.9	5	9.7	8	0.003
R1/4	0206 13 00	8	4.7	7.3	6	13.2	10	0.007
R3/8	0206 17 00	8	5.1	7.7	8	16.7	11	0.012
R1/2	0206 21 00	8	6.4	10	10	21	13	0.023
R3/4	0206 27 00	11	7.7	11.3	14	26.4	17	0.048
R1	0206 34 00	13	8.1	12.7	17	33.2	19	0.085
R1 1/4	0206 42 00	14	10.4	15	22	41.9	22	0.166
R1 1/2	0206 49 00	14	10.4	15	24	47.8	22	0.222

For BSPT plugs, from 1/2" - 1 1/2" inclusive

Conforms to DIN 906

Thread, conforms to EN 10226-1

0206 Internal Hexagon Head Plug, Male NPT Thread

Steel

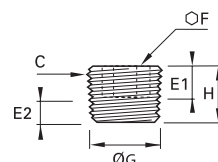

C		E1	E2 min	E2 max	F	G	H	Kg
NPT1/16	0206 08 00	6	3.8	6.4	4	7.8	7	0.002
NPT1/8	0206 11 00	6	3.2	5	5	10.2	8	0.003
NPT1/4	0206 14 00	8	4.4	7.2	6	13.6	10	0.007
NPT3/8	0206 18 00	8	4.7	7.5	8	17	11	0.012
NPT1/2	0206 22 00	8	6.3	9.9	10	21.2	13	0.023
NPT3/4	0206 28 00	11	6.8	10.4	14	26.6	17	0.048
NPT1	0206 35 00	13	8	12.4	17	33.2	19	0.082

0210 Hex Head Plug, Male BSPP and Metric Thread

Steel

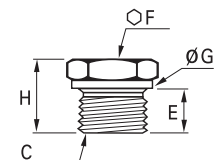

C		E	F	G	H	Kg
M8x1.25	0210 57 00	8	14	12	15	0.011
M10x1	0210 60 00	8	14	14	15	0.013
M12x1.25	0210 66 00	11	17	17	18	0.021
G1/8	0210 10 00	8	14	14	15	0.013
M14x1.25	0210 70 00	11	19	19	20	0.032
G1/4	0210 13 00	12	19	18	21	0.031
G3/8	0210 17 00	12	22	22	21	0.046
G1/2	0210 21 00	14	27	26	24	0.078
G3/4	0210 27 00	16	32	32	27	0.134
G1	0210 34 00	18	41	39	33	0.269
G1 1/4	0210 42 00	20	50	49	35	0.441

Profile of head undercut conforms to DIN 3852-1, form D/E

BSPP threads, ISO 228-1

Parallel metric threads, NFE 03-054

0216 Hex Head Plug, Male BSPT Thread

Steel

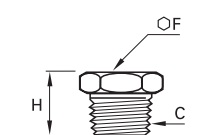

C		F	H	Kg
R1/8	0216 10 00	13	16	0.012
R1/4	0216 13 00	17	19	0.023
R3/8	0216 17 00	19	21	0.038
R1/2	0216 21 00	22	23	0.060

BSPT thread conforms to EN 10226-1

Steel Plugs

0216

Hex Head Plug, Male NPT Thread

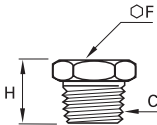
Steel		C		F	H	Kg
		NPT1/8	0216 11 00	13	16	0.012
		NPT1/4	0216 14 00	17	19	0.023
		NPT3/8	0216 18 00	19	21	0.038
		NPT1/2	0216 22 00	22	23	0.060

Stainless Steel Plugs

0285 Internal Hexagon Head Plug, Male BSPT Thread

Stainless steel 316L

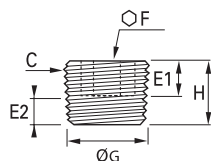

C		E1	E2 min	E2 max	F	G	H	Kg
R1/8	0285 10 00	6	3.1	4.9	5	9.7	8	0.003
R1/4	0285 13 00	8	4.7	7.3	6	13.2	10	0.007
R3/8	0285 17 00	8	5.1	7.7	8	16.7	11	0.013
R1/2	0285 21 00	8	6.4	10	10	21	13	0.024
R3/4	0285 27 00	11	7.7	11.3	14	26.4	17	0.051
R1	0285 34 00	13	8.1	12.7	17	33.2	19	0.089

0285 Internal Hexagon Head Plug, Male NPT Thread

Stainless steel 316L

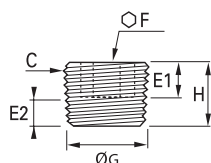

C		E1	E2 min	E2 max	F	G	H	Kg
NPT1/8	0285 11 00	6	3.2	5	5	10.2	8	0.003
NPT1/4	0285 14 00	8	4.4	7.2	6	13.6	10	0.007
NPT3/8	0285 18 00	8	4.7	7.5	8	17	11	0.013
NPT1/2	0285 22 00	8	6.3	9.9	10	21.2	13	0.025

Sealing Accessories

0138

Copper Washer

Copper

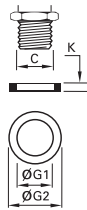

C		G1	G2	K	Kg
M6	0138 06 00	6.3	9	1	0.033
M8	0138 08 00	8.3	11	1	0.001
M12	0138 12 00	12.3	15.5	1.3	0.001
M14	0138 14 00	14.3	18	1.5	0.001
M16	0138 16 00	16.3	20	1.5	0.001
M18	0138 18 00	18.3	22	1.5	0.001
M20	0138 20 00	20.3	24	1.5	0.001
M22	0138 22 00	22.3	27	1.5	0.002
M24	0138 24 00	24.3	29	2	0.003
M26	0138 26 00	26.3	31	2	0.003
M30	0138 30 00	30.3	36	2	0.004
M36	0138 36 00	36.3	42	2	0.005
M39	0138 39 00	39.3	44	2	0.007
M45	0138 45 00	45.3	52	2	0.008
M52	0138 52 00	52.3	60	2	0.009
G1/8	0138 10 00	10.3	13.5	1	0.001
G1/4	0138 13 00	13.5	18	1.3	0.001
G3/8	0138 17 00	17.3	21	1.5	0.001
G1/2	0138 21 00	21.3	26	1.5	0.002
G3/4	0138 27 00	27.3	32	2	0.003
G1	0138 33 00	33.5	39	2	0.005
G1 1/4	0138 42 00	42.5	49	2	0.007
G1 1/2	0138 48 00	48.3	55	2	0.008
G2	0138 60 00	60	68	2.5	0.014

DIN 7603
ISO 65061

0137

Bonded Seal

Zinc-plated steel with NBR seal

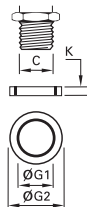

C		G1	G2	K	Kg
M12	0137 12 00	12.7	19	1.5	0.001
M14	0137 14 00	14.7	21	1.5	0.001
M16	0137 16 00	16.7	23	1.5	0.002
M18	0137 18 00	18.7	27	2	0.004
M20	0137 20 00	20.7	29	2	0.004
M22	0137 22 00	22.7	31	2	0.005
M24	0137 24 00	24.7	33	2	0.005
M30	0137 30 00	30.7	39	2	0.071
M39	0137 39 00	40	51	2.5	0.012
M45	0137 45 00	46	57	2.5	0.014
G1/8	0137 10 00	10.7	17	1.5	0.001
G1/4	0137 13 00	13.7	20.6	2.1	0.002
G3/8	0137 17 00	17.4	23.7	1.5	0.002
G1/2	0137 21 00	21.5	28.6	2.5	0.004
G3/4	0137 27 00	27	35.3	2	0.007
G1	0137 33 00	33.7	42	2	0.007
G1 1/4	0137 42 00	43	54	2.5	0.013
G1 1/2	0137 48 00	49	60	2.5	0.015
G2	0137 60 00	60.7	73	3	0.027

Note: to use these bonded seals successfully it is necessary to spot face around the female thread to provide a sealing "land".

The diameter should be 0.3 mm to 0.5 mm greater than the external diameter of the seal.

The surface finish of the thread should not exceed 12 µ.

Sealing Accessories

0605 Fluoropolymer Tape

FKM



Kg

0605 12 12

0.012

Can be used for temperatures from - 250°C to +260°C.

Chemically inert and resistant to gases, acids, solvents, hydrocarbons, oils, alkalines, steam etc.

Non-toxic, waterproof, self-lubricating.

In accordance with CFR21.

Can be used on all materials.

Used to facilitate the preparation of leak-free threaded joints.

Supplied on a reel, length = 12 m, width = 12.7 mm, thickness 0.08 mm.

0602 Captive Sealing Washer

Technical polymer

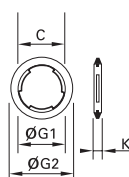

C



G1 G2 K Kg

M5x0.8	0602 29 93 15	5.2	7.8	1.5	0.001
G1/8	0602 23 10 20	10.3	14	2	0.001
G1/4	0602 23 11 20	13.7	17.5	2	0.001
G3/8	0602 23 12 20	17.2	21	2	0.001
G1/2	0602 23 13 20	21.5	25.5	2.5	0.002
G3/4	0602 27 32 20	27	32	2.5	0.001
G1	0602 30 60 20	33.8	39	3	0.001

Maximum allowable working pressure: 20 bar

0139 Bi-Material Captive Sealing Washer

Zinc-plated steel with NBR seal

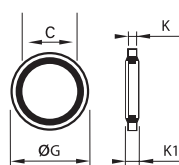

C



G K K1 Kg

G1/8	0139 10 00	14	1	1.7	0.001
G1/4	0139 13 00	17	1	1.7	0.001
G3/8	0139 17 00	22	1.2	2.1	0.001
G1/2	0139 21 00	26	1.6	2.5	0.002
G3/4	0139 27 00	32	1.5	2.5	0.003
G1	0139 34 00	39.6	1.7	2.6	0.003

Maximum allowable working pressure: 250 bar

Technical characteristics of captive seals 0602

Tightening torque



	M5x0.8	G1/8	G1/4	G3/8	G1/2	G3/4	G1
Min. Torque in daN.m	0.06	0.08	0.3	0.5	1	1.2	1.9
Max. Torque daN.m	0.16	0.8	1.2	3	3.5	6	9

Tube Supports

0127

Brass Tube Support for Polymer Tubing

Brass

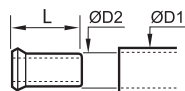

ØD1	ØD2		L	Kg
4	2	0127 04 00	11	0.001
	2.7	0127 04 27	11	0.001
5	3	0127 05 03	11	0.001
	3.3	0127 05 00	11.5	0.009
6	4	0127 06 00	11.5	0.001
	5.5	0127 08 55	14	0.001
8	6	0127 08 00	14	0.001
	7	0127 10 07	18	0.001
10	7.5	0127 10 75	18	0.001
	8	0127 10 00	18	0.002
8	8	0127 12 08	18	0.002
	9	0127 12 09	18	0.001
12	10	0127 12 00	18	0.001
	11	0127 14 11	18	0.002
14	12	0127 14 00	18	0.002
	15	0127 15 12	18	0.002
16	13	0127 16 13	18	0.003
18	14	0127 18 14	19.5	0.003
20	15	0127 20 15	20.5	0.003
22	16	0127 22 16	21	0.004
25	19	0127 25 19	25	0.007

This tube support guarantees good gripping, at high temperatures and pressures, by preventing collapsing of the tube.

1827

Stainless Steel Tube Support for Fluoropolymer Tubing

Stainless steel 316L

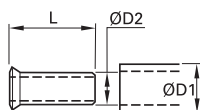

ØD1	ØD2		L	Kg
6	4	1827 06 00	11.5	0.001
8	6	1827 08 00	14	0.001
10	8	1827 10 00	18	0.001
12	9	1827 12 09	18	0.001
	10	1827 12 00	18	0.001
16	14	1827 16 00	18	0.002

This tube support is necessary when using fluoropolymer tubing at all temperatures compatible with the fitting/tubing assembly.