

XP POINT-OF-USE SERIES



FXP SERIES - STAINLESS STEEL FIBER MEDIA

DESCRIPTION

The FXP is an Ultra High Purity (UHP) gas filter that incorporates Mott's exclusive all fiber metal media. Made for non-corrosive gases, the FXP meets the demands of UHP gas delivery applications with a high filtration efficiency of particles down to 0.003 μm .

APPLICATIONS

UHP gas sticks for Semiconductor, LED, Photovoltaic, and MEMS Equipment Hookup. UHP filtration in valve manifold boxes, gas cabinets, tool isolation gas boxes, on-board gas delivery boxes or any process requiring ultra high purity particle removal.



OPERATING CONDITIONS

- » Maximum Operating Pressure: 3000 psig (206.8 barg)
- » Maximum Operating Temperature for Inert Gas: 460°C
- » Maximum Differential Pressure: 1000 psid (68.9 bar)

MATERIALS

- » Hardware: 316L SS
- » Filter Medium: 316L SS
- » Wetted Hardware Surface Finish: SEMI F19

SPECIFICATIONS

Particle Removal Size:	$\geq 0.003 \mu\text{m}$
Filter Efficiency (Log Reduction Value):	≥ 9 LRV (99.9999999% reduction in particles). Confirmed at the most penetrating particle size of 0.08 μm per SEMI F38-0699 test method
Helium Leak Rating:	1×10^{-9} atm cc/sec
Moisture Contribution:	<10 ppb after 1 hour at low-flow ambient purge per SEMI F27 test method
Total Hydrocarbons:	Below detectable limits per SEMASPEC 90120396B test method
Particle Shedding:	Zero particle contribution above background (<1 particle/ft ³) per SEMI F43-0308 test method

Warranty:
Mott Corporation ("Mott") warrants its XP filter will meet the specified retention and media integrity standards for a period of two years from the date of purchase, providing the filter is properly installed and used in accordance with the specified flow, pressure, temperature, and chemical compatibility as published by Mott. Mott will replace or grant a purchase price refund for any XP filter which proves defective under the terms of this limited warranty. No other remedies apply. Mott disclaims all other warranties, either expressed or implied, including any warranty of merchantability or fitness for a particular purpose. Mott shall have no liability for consequential incidental, special or punitive damages, lost profits or savings, or damages from lost production or damage to other materials.

FLOW DATA

Mott FXP331 Flow Rate vs. Differential Pressure
Typical Flow Curves as a Function of System Pressures

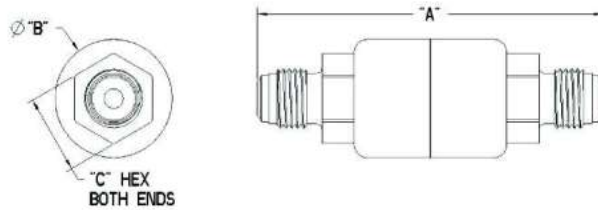
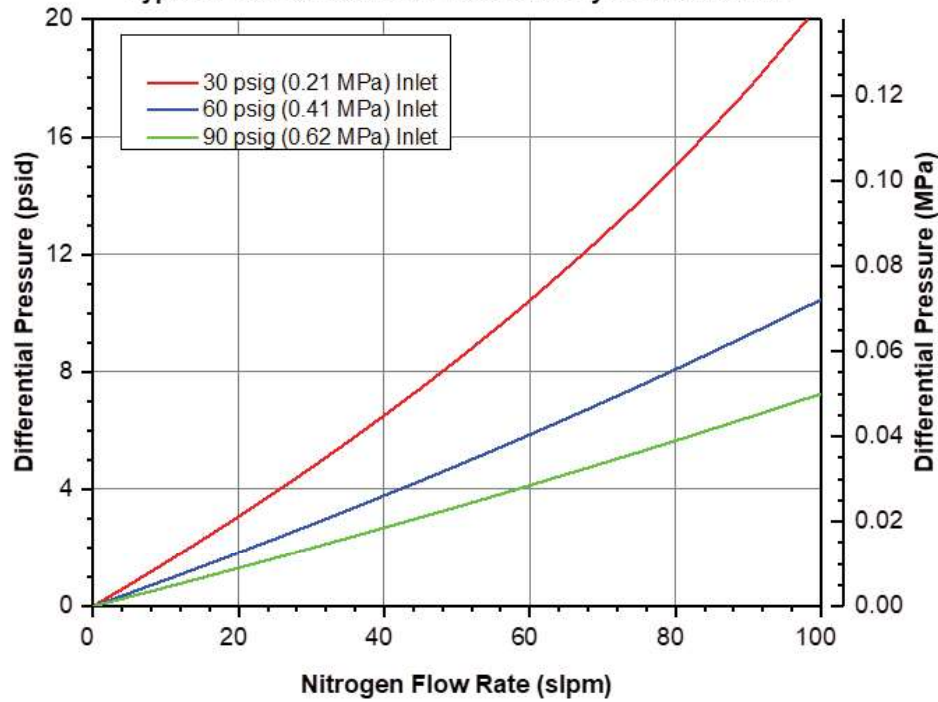

ORDERING INFORMATION

Part Description	Part Number	Fitting Type	A Inches/mm	B Inches/mm	C Inches/mm
FXP331FF11	6900111	1/4 inch Male/Male Face Seal	3.31/84.1	1.125/28.6	0.75/19.1
FXP331FF33	6900112	1/2 inch Male/Male Face Seal	3.31/84.1	1.125/28.6	0.875/22.2

*Custom designs and fittings available. Contact a Mott representative for more information.