



HANLEY CONTROLS
CLONMEL



The 10, 11 and 12 Rectus Moldtite coupling series were especially developed for connecting coolant lines and injection moulds. These stand out for their convenient, single-handed operation and a reliable O-ring seal. Widely used in Europe.

- Available in:
 - single shut-off, double shut-off or straight-through versions
- The straight-through couplings are equipped with nickel plated sleeves for quick and accurate visual differentiation
- The angular connections prevent kinks from forming in the hose
- Available on request:
 - series 10/11 are also available with special FFKM high-temperature seal for applications up to constant temperature 200°C

Series 10



Series 11



Series 12

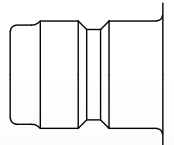

European Profile

KF Straight-Through

Working Pressure*:
up to 15 bar

Material:

- Coupling: Brass
- Plug: Brass, stainless steel
- Seals: FKM

Working Temperature:
-15°C up to +200°C (FKM)

Flow Rate Water:

- Series 10: 16 l/min.
- Series 11: 50 l/min.
- Series 12: 106 l/min.

pressure drop 0.5 bar

KA Single Shut-Off

Working Pressure*:
up to 15 bar

Material:

- Coupling: Brass
- Plug: Brass, stainless steel
- Seals: FKM

Working Temperature:
-15°C up to +200°C (FKM)

Flow Rate Water:

- Series 10: 8 l/min.
- Series 11: 20 l/min.
- Series 12: 38 l/min.

pressure drop 0.5 bar

KB Double Shut-Off

Working Pressure*:
up to 15 bar

Material:

- Coupling: Brass
- Plug: Brass
- Seals: FKM

Working Temperature:
-15°C up to +200°C (FKM)

Flow Rate Water:

- Series 10: 7 l/min.
- Series 11: 15 l/min.
- Series 12: 28 l/min.

pressure drop 0.5 bar

* maximum static working pressure with design factor 4 to 1.

→|← Straight-Through

10/11/12KFA Coupler without valve, Male Thread

Brass, FKM

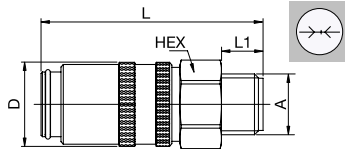

DN	Series	A	HEX	L	L1	D
6	10	M14 x 1.5	10KFA14MVX	17	48	9 18
		G1/4	10KFA13MVX	17	48	9 18
		G3/8	10KFA17MVX	19	48	9 18
9	11	G1/4	11KFA13MVX	22	51.5	9 23
		M16 x 1.5	11KFA16MVX	22	51.5	9 23
		G3/8	11KFA17MVX	22	51.5	9 23
13	12	G1/2	12KFA21MVX	30	74	12 32
		G3/4	12KFA26MVX	30	78	16 32

→|← Straight-Through

10/11KFAR Coupler without valve, Male Thread 90°

Brass, FKM

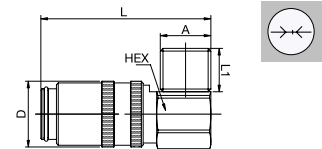
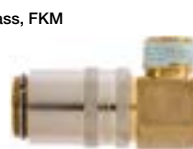

DN	Series	A	HEX	L	L1	D
6	10	G1/4	10KFAR13MVX	17	47	12 18
		M14 x 1.5	10KFAR14MVX	17	47	12 18
9	11	M16 x 1.5	11KFAR16MVX	22	53.5	12 23

10/11KFAH Coupler without valve, Male Thread 45°

Brass, FKM

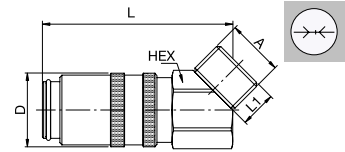

DN	Series	A	HEX	L	L1	D
6	10	G1/4	10KFAH13MVX	17	47	9 18
		M14 x 1.5	10KFAH14MVX	17	47	9 18
9	11	M16 x 1.5	11KFAH16MVX	22	53.5	9 23

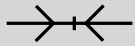

Straight-Through

10/11KFIW Coupler without valve, Female Thread

Brass, FKM

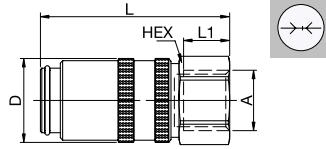

DN	Series	A	HEX	L	L1	D	
6	10	G1/4	10KFIW13MVX	17	41	10	18
		G3/8	10KFIW17MVX	19	45	10	18
9	11	G1/4	11KFIW13MVX	21	46.5	10	23
		G3/8	11KFIW17MVX	21	46.5	10	23

10/11/12KFTF Coupler without valve, Hose Barb

Brass, FKM

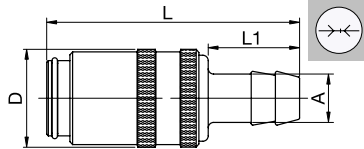

DN	Series	A	L	L1	D	
6	10	9	10KFTF09MVX	52	22	18
9	11	13	11KFTF13MVX	61.5	25	23
13	12	19	12KFTF19MVX	90	32	32

10/11/12KFTR Coupler without valve, Hose Barb 90°

Brass, FKM

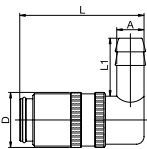

DN	Series	A	L	L1	D	
6	10	9	10KFTR09MVX	41	22	18
9	11	13	11KFTR13MVX	51	28.5	23
13	12	19	12KFTR19MVX	78	32	32

10/11/12KFTH Coupler without valve, Hose Barb 45°

Brass, FKM

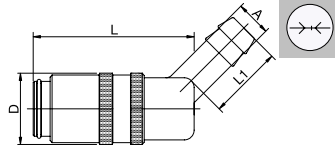

DN	Series	A	L	L1	D	
6	10	9	10KFTH09MVX	52	22	18
9	11	13	11KFTH13MVX	51	25	23
13	12	19	12KFTH19MVX	78	30	32

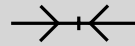

Straight-Through

10/11KFTP Coupler without valve, Push-Lok

Brass, FKM

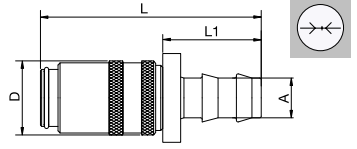

DN	Series	A	L	L1	D	
6	10	6	10KFTP06MVX	50.5	20.4	18
		10	10KFTP10MVX	54	24.2	18
9	11	10	11KFTP10MVX	61	24.2	23
		13	11KFTP13MVX	64.5	27.9	23

10/11KFPR Coupler without valve, Push-Lok 90°

Brass, FKM

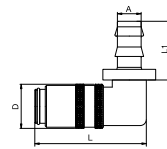

DN	Series	A	L	L1	D	
6	10	6	10KFPR06MVX	46	20.4	18
		10	10KFPR10MVX	46	24.2	18
9	11	10	11KFPR10MVX	56.5	24.2	23
		13	11KFPR13MVX	56.5	27.9	23

10/11KFPH Coupler without valve, Push-Lok 45°

Brass, FKM

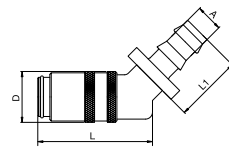

DN	Series	A	L	L1	D	
6	10	6	10KFPH06MVX	41	20.4	18
		10	10KFPH10MVX	41	24.2	18
9	11	10	11KFPH10MVX	51	24.2	23
		13	11KFPH13MVX	51	27.9	23

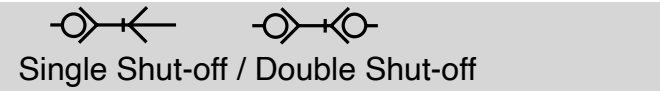

10/11/12KBA Coupler with valve, Male Thread

Brass, FKM

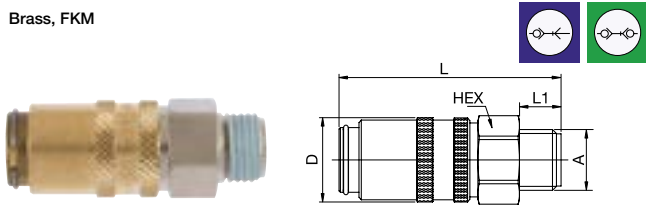

DN	Series	A	HEX	L	L1	D
6	10	M14 x 1.5 10KBAM14MVX	17	48	9	18
		G1/4 10KBAW13MVX	17	48	9	18
		G3/8 10KBAW17MVX	19	48	9	18
9	11	G1/4 11KBAW13MVX	22	51.5	9	23
		M16 x 1.5 11KBAM16MVX	22	51.5	9	23
		G3/8 11KBAW17MVX	22	51.5	9	23
13	12	G1/2 11KBAW21MVX	22	51.5	12	23
		G3/4 12KBAW26MVX	30	74	12	32

10/11KBAR Coupler with valve, Male Thread 90°

Brass, FKM

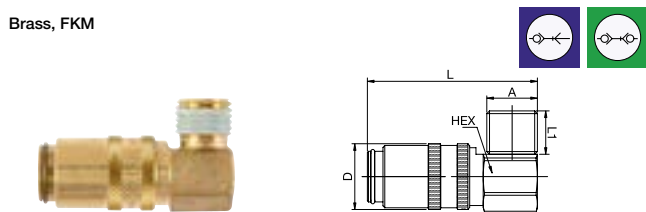

DN	Series	A	HEX	L	L1	D
6	10	G1/4 10KBAR13MVX	17	47	12	18
		M14 x 1.5 10KBAR14MVX	17	47	12	18
9	11	M16 x 1.5 11KBAR16MVX	22	53.5	12	23

10/11KBAH Coupler with valve, Male Thread 45°

Brass, FKM

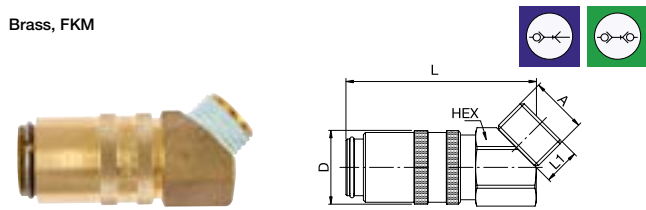

DN	Series	A	HEX	L	L1	D
6	10	G1/4 10KBAH13MVX	17	47	9	18
		M14 x 1.5 10KBAH14MVX	17	47	9	18
9	11	M16 x 1.5 11KBAH16MVX	22	53.5	9	23

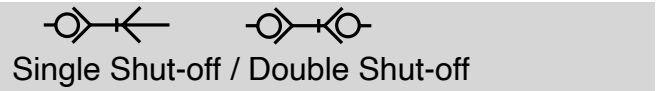

10/11KBIW Coupler with valve, Female Thread

Brass, FKM

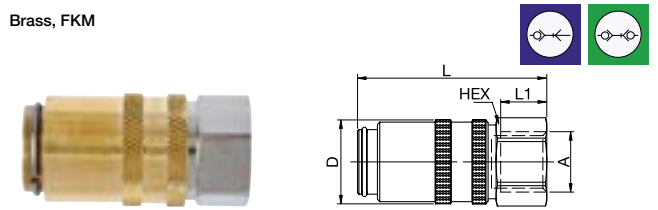

DN	Series	A	HEX	L	L1	D
6	10	G1/4 10KBIW13MVX	17	41	12	18
		G3/8 10KBIW17MVX	19	45	12	18
9	11	G1/4 11KBIW13MVX	21	46.5	10	23
		G3/8 11KBIW17MVX	21	46.5	10	23

10/11/12KBTf Coupler with valve, Hose Barb

Brass, FKM

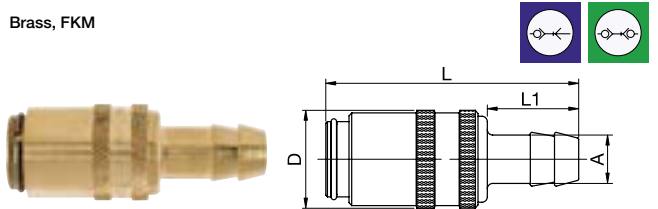

DN	Series	A	L	L1	D
6	10	9	52	22	18
9	11	13	61.5	25	23
13	12	19	90	32	32

10/11/12KBTR Coupler with valve, Hose Barb 90°

Brass, FKM

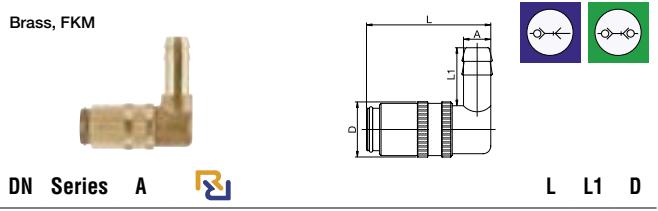

DN	Series	A	L	L1	D
6	10	9	41	22	18
9	11	13	51	28.5	23
13	12	19	78	32	32

10/11/12KBTH Coupler with valve, Hose Barb 45°

Brass, FKM

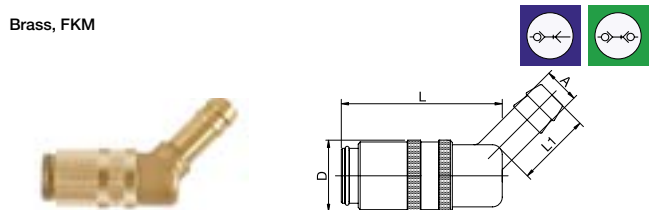

DN	Series	A	L	L1	D
6	10	9	52	22	18
9	11	13	51	25	23
13	12	19	78	30	32



Single Shut-off / Double Shut-off

10/11KBTP Coupler with valve, Push-Lok

Brass, FKM

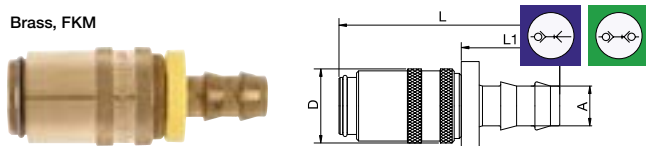

DN	Series	A		L	L1	D
6	10	6	10KBTP06MVX	50.5	20.4	18
		10	10KBTP10MVX	54	24.2	18
9	11	10	11KBTP10MVX	61	24.2	23
		13	11KBTP13MVX	64.5	27.9	23

10/11KBPR Coupler with valve, Push-Lok 90°

Brass, FKM

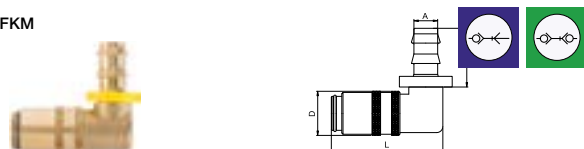

DN	Series	A		L	L1	D
6	10	6	10KBPR06MVX	46	20.4	18
		10	10KBPR10MVX	46	24.2	18
9	11	10	11KBPR10MVX	56.5	24.2	23
		13	11KBPR13MVX	56.5	27.9	23

10/11KBPH Coupler with valve, Push-Lok 45°

Brass, FKM

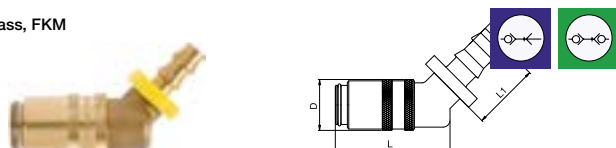

DN	Series	A		L	L1	D
6	10	6	10KBPH06MVX	41	20.4	18
		10	10KBPH10MVX	41	24.2	18
9	11	10	11KBPH10MVX	51	24.2	23
		13	11KBPH13MVX	51	27.9	23



Straight-Through / Single Shut-off

10/11/12SFA Plug without valve, Male Thread

Brass or stainless steel

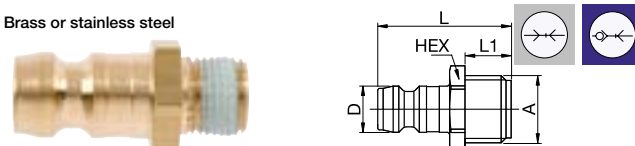

DN	Series	A		HEX	L	L1	D	Version	
6	10	M8 x 0.75	10SFAM08MXX	11	24	7	9	Brass	
		M10 x 1	10SFAM10MXX	11	24	7	9	Brass	
		M10 x 1	10SFAM10RXX	11	24	7	9	AISI 303	
		G1/8	10SFAW10MXN	11	24	7	9	Nickel-plated brass	
		G1/8	10SFAW10RXX	11	24	7	9	AISI 303	
		M12 x 1.5	10SFAM12MXX	14	27	10	9	Brass	
	9	11	G1/4	10SFAW13MXN	15	26	9	9	Nickel-plated brass
			G1/4	10SFAW13RXX	15	26	9	9	AISI 303
			M14 x 1.5	10SFAM14MXX	15	26	9	9	Brass
			G3/8	10SFAW17MXN	17	30	10	9	Nickel-plated brass
			G1/8	11SFAW10MXN	14	25	8	13.5	Nickel-plated brass
			G1/4	11SFAW13MXN	15	26	9	13.5	Nickel-plated brass
13	12	G1/4	11SFAW13RXX	15	26	9	13.5	AISI 303	
		M14 x 1.5	11SFAM14MXX	15	26	9	13.5	Brass	
		M16 x 1.5	11SFAM16MXX	17	26	9	13.5	Brass	
		G3/8	11SFAW17MXN	17	26	9	13.5	Nickel-plated brass	
		G3/8	11SFAW17RXX	17	26	9	13.5	AISI 303	
		G1/2	12SFAW21MXN	22	47	12	19	Nickel-plated brass	
G3/4	12SFAW26MXN	27	51	16	19	Nickel-plated brass			

10/11SFAR Plug without valve, Male Thread 90° tapered

Brass

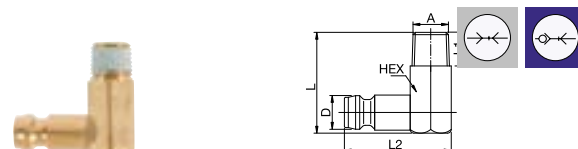

DN	Series	A		HEX	L	L1	L2	D	Version
6	10	M10 x 1	10SFAR10MXX	11	27	9	28.5	9	Brass
		R1/8	10SFAR10MXN	11	27	9	28.5	9	Nickel-plated brass
		R1/4	10SFAR13MXN	11	27	9	28.5	9	Nickel-plated brass
9	11	R1/4	11SFAR13MXN	15	34	11	32	13.5	Nickel-plated brass
		R3/8	11SFAR17MXN	15	34	11	32	13.5	Nickel-plated brass

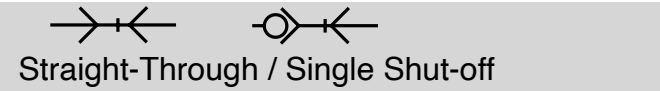

10/11SFIW Plug without valve, Female Thread

Brass

DN	Series	A		HEX	L	L1	D
6	10	G1/8	10SFIW10MXN	11	24	9	9
		G1/4	10SFIW13MXN	16	27	9	9
9	11	G1/4	11SFIW13MXN	16	33	10	13.5

10/11/12SFTF Plug without valve, Hose Barb

Brass

DN	Series	A		L	L1	D
6	10	9	10SFTF09MXX	38	22	9
9	11	9	11SFTF09MXX	41	25	13.5
		13	11SFTF13MXX	41	25	13.5
13	12	19	12SFTF19MXX	61	32	19

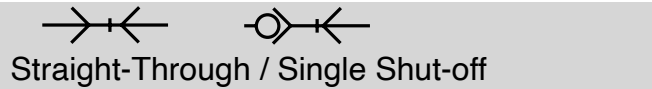

10/11/12SBA Plug with valve, Male Thread

Brass, FKM

DN	Series	A		HEX	L	L1	D	Version
6	10	G1/4	10SBAW13MVN	15	29	12	9	Nickel-plated brass
		M14 x 1.5	10SBAM14MVX	15	29	12	9	Brass
9	11	G1/4	11SBAW13MVN	15	31	12	13.5	Nickel-plated brass
		M16 x 1.5	11SBAM16MVX	17	30	12	13.5	Brass
		G3/8	11SBAW17MVN	17	30	12	13.5	Nickel-plated brass
13	12	G3/4	12SBAW26MVN	27	51	16	19	Nickel-plated brass



10/11VN Extension Plug, continuous Male Thread

Brass

DN	Series	A		HEX	L	L1	D
6	10	G1/8	10VN1010MXX	11	100	60	9
		G1/4	10VN1310MXX	14	100	60	9
9	11	G1/4	11VN1310MXX	14	100	60	13.5
		G3/8	11VN1710MXX	19	100	60	13.5

10/11VNXX Extension Plug, without Thread

Brass

DN	Series	A		HEX	L	L1	D
6	10	8	10VNXX10MXX	9	100	79	9
		10	10VNXX12MXX	11	120	100	9
		10	10VNXX24MXX	11	240	220	9
9	11	14	11VNXX15MXX	15	150	125	13.5
		14	11VNXX30MXX	15	300	275	13.5