

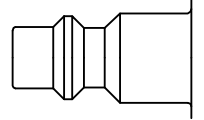

Rectus premium industrial coupling 1/4" according to ISO 6150 B. Suitable for compressed air applications with greater than average air consumption. Coupling system with single-hand operation. Ultra High Flow valve for optimum flow and low pressure drop.

- Available on request:
 - with additional end connections
 - other seals for different temperature ranges and fluids



ISO B Profile



HANLEY CONTROLS
CLONMEL

Dust Protections (P. 357)
for Coupling Part.-No. SK23S

KA Single Shut-Off

Working Pressure*:
up to 35 bar

Material:

- Coupling: Nickel plated brass, QPQ treated steel
- Plug: Nickel plated steel or brass
- Seals: NBR

Working Temperature:
-20°C up to +100°C (NBR)

Flow Rate Air:
950 l/min.
inlet pressure 6 bar, pressure drop 0.5 bar

Flow Rate Water:
13 l/min.
pressure drop 0.5 bar

* maximum static working pressure with design factor 4 to 1.

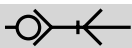

Single Shut-Off

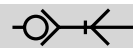

Single Shut-Off

1400KAAK Coupler with valve, Male Thread

Nickel-plated brass, Steel QPQ treated, NBR

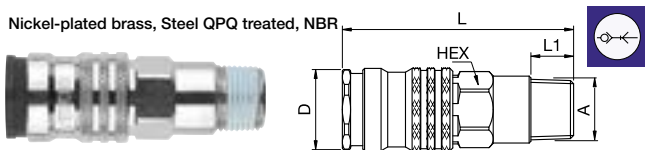

A	HEX	L	L1	D
R1/4 1400KAAK13SPN	19	65	12	23
R3/8 1400KAAK17SPN	19	65	12	23
R1/2 1400KAAK21SPN	22	59.5	17	23

1400KATF Coupler with valve, Hose Barb

Nickel-plated brass, Steel QPQ treated, NBR

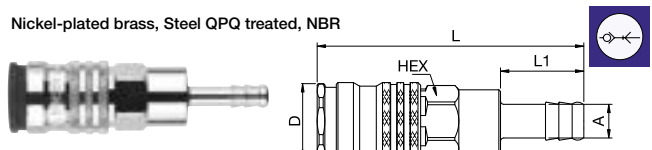

A	HEX	L	L1	D
6 1400KATF06SPN	19	80	25	23
8 1400KATF08SPN	19	80	25	23
9 1400KATF09SPN	19	80	25	23
10 1400KATF10SPN	19	80	25	23
13 1400KATF13SPN	19	80	25	23

1400KAIW Coupler with valve, Female Thread

Nickel-plated brass, Steel QPQ treated, NBR

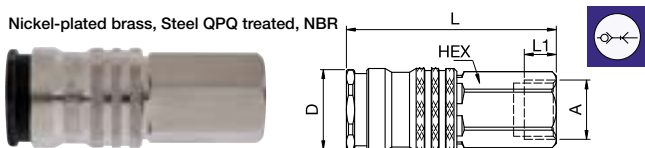

A	HEX	L	L1	D
G1/4 1400KAIW13SPN	19	59	9	23
G3/8 1400KAIW17SPN	19	59	9	23
G1/2 1400KAIW21SPN	24	62	12	23

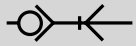

Single Shut-Off



23SFA Plug without valve, Male Thread

Nickel-plated steel or brass

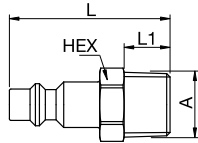

A			HEX	L	L1	Version
R1/8			13	39	9	Nickel-plated steel
G1/8			14	35	7	Nickel-plated steel
R1/4			14	42	12	Nickel-plated steel
G1/4			14	42	12	Nickel-plated steel
G1/4			14	42	12	Brass
R3/8			17	42	12	Nickel-plated steel
G3/8			17	42	12	Brass
G3/8			17	42	12	Nickel-plated steel
R1/2			22	48	17	Nickel-plated steel
G1/2			22	42	12	Nickel-plated steel

23SFIW Plug without valve, Female Thread

Nickel-plated steel

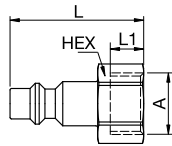

A			HEX	L	L1
G1/8			14	36	9
G1/4			17	36	9
G3/8			19	36	9
G1/2			24	39	12

23SFTF Plug without valve, Hose Barb

Nickel-plated steel or brass

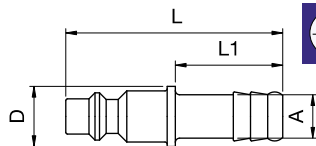

A			L	L1	D	Version
6			51	25	14	Nickel-plated steel
6			51	25	14	Brass
8			51	25	14	Nickel-plated steel
9			51	25	14	Nickel-plated steel
9			51	25	14	Brass
10			51	25	14	Nickel-plated steel
13			51	25	14	Nickel-plated steel