

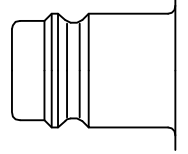

Brass coupling with no valve for applications with liquids in the pressure range up to 35 bar. The couplings are corrosion resistant. The system stands out for a high flow with minimal pressure drop.

- Available on request:
  - with additional end connections
  - other seals for different temperature ranges and fluids



various Profile



## **KF** Straight-Through

**Working Pressure\*:**  
up to 35 bar

**Material:**

- Coupling: Nickel plated brass
- Plug: Nickel plated steel
- Seals: NBR

**Working Temperature:**

-20°C up to +100°C (NBR)

**Flow Rate Water:**

58 l/min.

pressure drop 0.5 bar

\* maximum static working pressure with design factor 4 to 1.



Straight-Through

### 41KFAW Coupler without valve, Male Thread

Nickel-plated brass, NBR

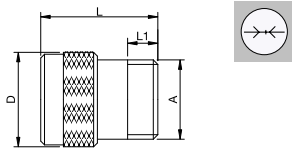

**A** 

**L L1 D**

G1/2 **41KFAW21MPN**

31 8 25

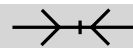

Straight-Through

### 41KFTF Coupler without valve, Hose Barb

Nickel-plated brass, NBR

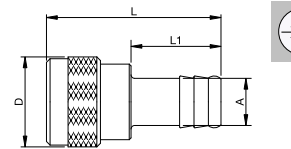

**A** 

**L L1 D**

13 **41KFTF13MPN**

48.5 25 25

19 **41KFTF19MPN**

48.5 25 25

### 41KFIW Coupler without valve, Female Thread

Nickel-plated brass, NBR

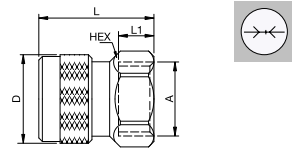

**A** 

**HEX L L1 D**

G1/2 **41KFIW21MPN**

24 32.5 10 25

### 41SFAW Plug without valve, Male Thread

Nickel-plated brass

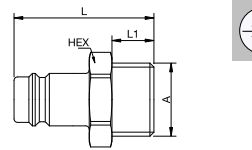

**A** 

**HEX L L1**

G1/2 **41SFAW21MXN**

24 40 12



Straight-Through

## 41SFIW Plug without valve, Female Thread

Nickel-plated brass

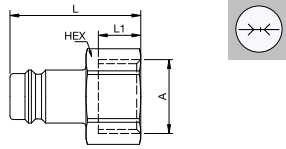
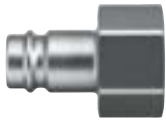

A



HEX L L1

G1/2 41SFIW21MXN

24 37 12

## 41SFTF Plug without valve, Hose Barb

Nickel-plated brass

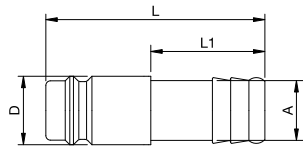

A



L L1 D

13 41SFTF13MXN

48 25 15

19 41SFTF19MXN

49 25 21