

Dwyer

SERIES 647



www.hccl.ie

# WET/WET DIFFERENTIAL PRESSURE TRANSMITTER

Ranges from 0 to 25 in w.c., ±1.0% Accuracy, NEMA 4 (IP56) Enclosure, 2-Wire



[4] 1/4 [6.35] LONG X 7/32 [5.56] WIDE MOUNTING HOLES

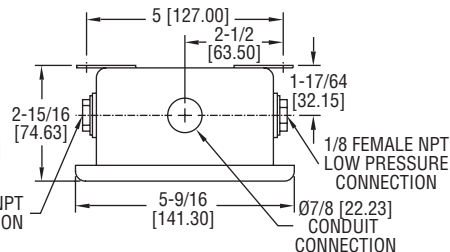
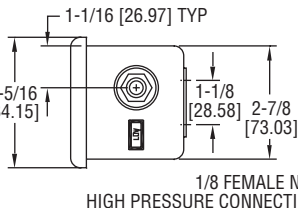

Monitor differential pressure in air/liquid flow systems, HVAC automation, pneumatic systems and process control with the **SERIES 647** Wet/Wet Differential Pressure Transmitter. Units are temperature compensated and provide a 4 to 20 mA output signal which can be interfaced with chart recorders, data loggers and computerized monitoring and control systems.

### FEATURES/BENEFITS

- Versatile for liquid or gas supports designs requiring more precise measurements in support of application
- Temperature compensated improves performance of device for accurate measurement under different operating environments.
- Output signal provides capability to interface with automation systems to centralize monitoring

### APPLICATIONS

- Flow
- Process control
- HVAC automation
- Pneumatic systems

MODEL CHART			
Model	Range	Model	Range
647-0	0 to 1 in w.c.	647-3	0 to 5 in w.c.
647-1	0 to 3 in w.c.	647-4	0 to 10 in w.c.
647-2	0 to 25 in w.c.		

### SPECIFICATIONS

**Service:** Compatible gases or liquids on both pressure and reference sides.  
**Wetted Materials:** Brass, vinyl, glass-filled polyester, silicon, and fluorosilicone.  
**Accuracy:** ±1.0% FS.  
**Stability:** ±1.5% FS output/year.  
**Temperature Limits:** 32 to 122°F (0 to 50°C).  
**Pressure Limits:** Ranges 1 in w.c. to 5 psi: 20 psi, 15 psi range: 45 psi, 30 psi range: 60 psi.  
**Thermal Effects:** Zero: ±0.05% FS/°F, Span: ±0.05% rdg/°F.

**Power Requirements:** 18 to 30 VDC.  
**Output Signal:** 4 to 20 mA, 2-wire.  
**Zero and Span Adjustments:** Adjustable, ±10%.  
**Loop Resistance:** 400Ω @ 18 VDC, 600Ω @ 24 VDC, 1000Ω @ 30 VDC.  
**Electrical Connection:** Screw terminals, reverse polarity protected.  
**Process Connections:** Two 1/8" female NPT.  
**Housing:** Gasketed steel epoxy painted, NEMA 4 (IP56).  
**Weight:** 14 oz (397 g).

### OPTION

Use order code:	Description
NISTCAL-PT1	NIST traceable calibration certificate

PRESSURE