

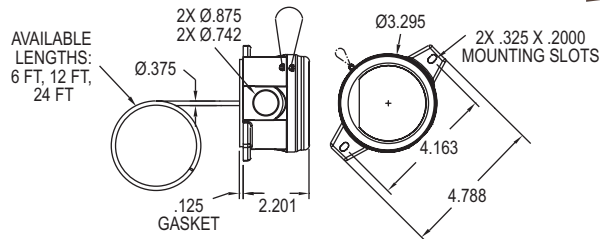

AVERAGING TEMPERATURE SENSOR

Available in 6', 12' and 24' Lengths



The **Series TE-A Averaging Temperature Sensor** features a long bendable aluminum capillary to measure the average temperature in large ducts and air handler units.

FEATURES/BENEFITS

- Easy to mount external tab housing
- 1/4 turn housing cover with chain
- Multiple conduit knockouts for easy installation positioning

APPLICATIONS

- Building automations
- Air handler unit monitoring
- Large air duct temperature monitoring

SPECIFICATIONS

Accuracy: Thermistor temperature sensor: $\pm 0.22^{\circ}\text{C}$ @ 25°C ($\pm 0.4^{\circ}\text{F}$ @ 77°F).
Temperature Limits: -40 to 302°F (-40 to 150°C).
Capillary Lengths: 6, 12 or 24' (depending on model).
Cable Length: 4".
Sensor Curves: See page reference 1 below.
Probe Material: Bendable aluminum probe.
Housing Material: Meets UL, 94 V-0 polycarbonate plastic.
Weight: 14 oz (397 g).

MODEL CHART

Model	Sensor Type	Capillary Length	Model	Sensor Type	Capillary Length
TE-AAG-A0634-00	10k type III NTC thermistor	6'	TE-AAG-C0634-00	3k NTC thermistor	6'
TE-AAG-A1234-00	10k type III NTC thermistor	12'	TE-AAG-C1234-00	3k NTC thermistor	12'
TE-AAG-A2434-00	10k type III NTC thermistor	24'	TE-AAG-C2434-00	3k NTC thermistor	24'
TE-AAG-B0634-00	10k type II NTC thermistor	6'	TE-AAG-F0634-00	20k NTC thermistor	6'
TE-AAG-B1234-00	10k type II NTC thermistor	12'	TE-AAG-F1234-00	20k NTC thermistor	12'
TE-AAG-B2434-00	10k type II NTC thermistor	24'	TE-AAG-F2434-00	20k NTC thermistor	24'

AVERAGING TEMPERATURE SENSOR CLIPS

Model	Color	Sensor Diameter Size
CC1-N	Natural	3/8", 1/4", or 1/8"
CC1-GY	Grey	3/8", 1/4", or 1/8"

Note: Sold individually