

Models-1011, 1012, 1013, 1014. Aluminium Case & Brass Internals

Case

Aluminium Stove Enamelled Finish.
Solid front between bourdon tube and dial.

Bezel

Brass with Chrome Finish

Socket

Brass
Stainless Steel

Element

Bourdon Tube
Beryllium copper
Phosphor Bronze
Stainless Steel

Thread

1/8", 1/4", 3/8", 1/2" NPT, BSP, BSPT

Movement

Brass / Stainless Steel

Dial

White Aluminium (Black Printing)

Pointer

Black Aluminium

Window

Laminated Safety Glass

Standard Size

63, 100, 150mm

Accuracy class

1%

Scale Range

Vacuum to 1,000 bar (14,500 psi)

Ordering information

State:- Pressure gauge model
/Nominal size / Scale range
/ Size and location of connection / Optional extras reqd.



Model - 1012

Optional extras

200 & 250mm dia gauges.
White plastic dial (Black Printing).
Micro adjustable pointer / Black Finish.
Other pressure connections.
Monel to Nace MR-01-75,
Perspex window.
Customer logo.
Vibragauge®
Snubbagauge®
Further options: on request

We manufacture a wide range of instruments to customer's special requirements
We shall be pleased to discuss and advise on your specifications.

Specifications and dimensions given in this leaflet represent the state of engineering at the time of printing.
Engineering modifications may take place without prior notice.



HANLEY CONTROLS

CLONMEL

www.hccl.ie

Models-1011, 1012, 1013, 1014. Aluminium Case & Brass Internals

Surface Mounted
Model - 1011

Direct Mounted
(Standard)
Model - 1012

Flush Mounted
Screw Fixing
Model - 1013

Flush Mounted
Clamp Fixing
Model - 1014

Bottom connect

Rear connect

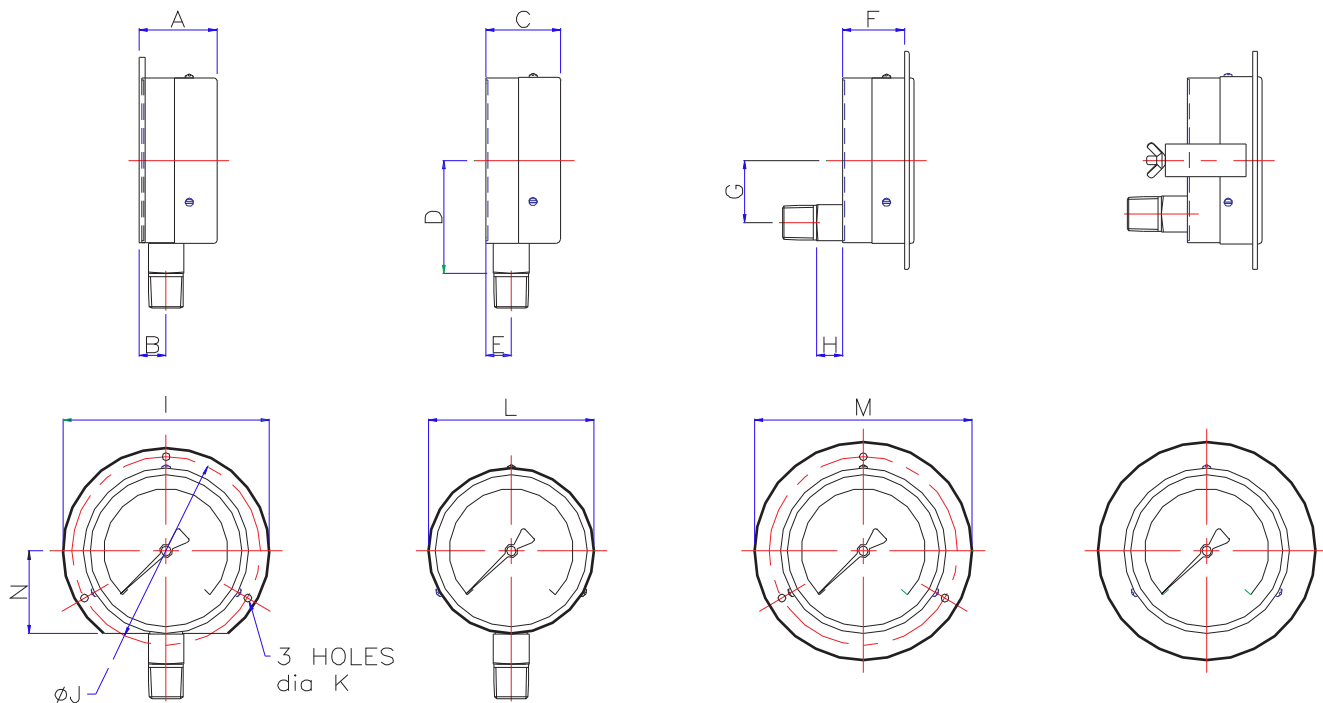

Dimensions Diameter	A	B	C	D	E	F	G	H	I	J	K	L	M	N	Panel Cut-out
63	35	11	35	38.5	11	29	21	6	86	75	3.6	65	90	32	70
100	49	18	45	70	17.5	49	32	13	130	118	6	103	135	51	106
150	53	17.5	50	92	18	50	32	13	183	168	6	153	185	75.5	155

Gas and Steam in excess of 25 Bar pressure can represent danger if there is a rupture in the Bourdon Tube measuring this gas. To minimize the danger, gauges in this application should be Safety Pattern type, having solid front between Bourdon tube and dial, safety window and blow-out back to allow any blast to release to the rear of gauge.
Although there is not necessarily any great risk in the use of gauges for gases at pressure less than 25 Bar, a blow-out disc should be incorporated and the purchaser should have regard to the nature of the gas and the installation conditions and, if necessary, order a gauge of the Safety Pattern type.
Surface mounted gauges should be fitted with distance pieces of not less than 3/4" (20mm) long to allow them to be mounted away from wall or panel.



HANLEY CONTROLS

CLONMEL

www.hccl.ie