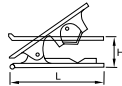

## 3000 71 00 Tube Cutter

Technical polymer

**H L Kg**

3000 71 00	25	79	0.029
------------	----	----	-------

This tool is designed to give a clean cut at right angles to the tube axis for all resilient polymer tubing (polyamide, polyurethane, FEP, polyethylene, etc.) from 4 mm to 16 mm diameter inclusive.

Replacement blades: part number 3000 71 00 05

A spring maintains the cutter in the closed position.

## 3000 71 11 Tube Cutter

Treated steel

**Kg**

3000 71 11	0.280
------------	-------

Replacement blades: part number 3000 71 11 05

## 6000 71 00 Stripping Tool for Anti-Spark Tubing

Polymère technique, acier inox

**Kg**

6000 71 00	0.098
------------	-------

## 1827 Stainless Steel Tube Support for Fluoropolymer Tubing

Stainless steel 316L

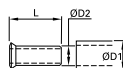

**ØD1 ØD2 L Kg**

6	4	1827 06 00	11.5	0.001
8	6	1827 08 00	14	0.001
10	8	1827 10 00	18	0.001
12	9	1827 12 09	18	0.001
12	10	1827 12 00	18	0.001
16	13	1827 16 13	18	0.002
16	14	1827 16 00	18	0.002

This tube support is necessary when using fluoropolymer tubing at all temperatures compatible with the fitting/tubing assembly.

## 0127 Brass Tube Support for Polymer Tubing

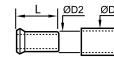
Brass



ØD1	ØD2	L	Kg
4	2	0127 04 00	11 0.001
4	2.7	0127 04 27	11 0.001
5	3	0127 05 03	11 0.001
5	3.3	0127 05 00	11.5 0.001
6	4	0127 06 00	11.5 0.001
8	5.5	0127 08 55	14 0.001
8	6	0127 08 00	14 0.001
10	7	0127 10 07	18 0.001
10	7.5	0127 10 75	18 0.001
10	8	0127 10 00	18 0.002
12	8	0127 12 08	26 0.002
12	9	0127 12 09	18 0.002
12	10	0127 12 00	18 0.001
14	11	0127 14 11	16 0.002
14	12	0127 14 00	18 0.002
15	12	0127 15 12	18 0.002
16	13	0127 16 13	18 0.003
18	14	0127 18 14	19.5 0.003
22	16	0127 22 16	21 0.005

This tube support guarantees good gripping, at high temperatures and pressures, by preventing collapsing of the tube.

## CLIP Clip Strip for Tubing and Fittings

Technical polymer

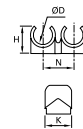

ØD	H	K	N	K	Kg	
4	CLIP 04 00	9	13.5	10.5	13.5	0.007
6	CLIP 06 00	10.5	13	10.5	13	0.008
8	CLIP 08 00	12.5	10.5	12	10.5	0.007
10	CLIP 10 00	14	12	15	12	0.005
12	CLIP 12 00	16.5	14	16.5	14	0.009
14	CLIP 14 00	18	16	20.5	16	0.009

Delivered in boxes of 10 strips of the same diameter (complete with self-tapping screws of 95 mm length) These clips can be used with metric or inch tubing.

## 0697 Clip for Braided Tubing

Treated steel

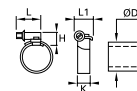

ØD	H	K	L	L1	K	Kg	
6-11	0697 00 01	7	5	12	7	5	0.004
10-16	0697 00 02	12	9	21	13	9	0.011
12-22	0697 00 03	12	9	21	13	9	0.014
16-27	0697 00 04	12	9	24	13	9	0.015
20-32	0697 00 05	12	9	24	13	9	0.016

## UR Threaded Nut

Brass



C		HEX	L
G1/8 right	<b>UR10</b>	12	11
G1/4 right	<b>UR13</b>	17	15.5
G3/8 right	<b>UR17</b>	19	16.5
G1/4 r. f. 9 mm	<b>UR13/9*</b>	17	15.5
G1/2 right	<b>UR21</b>	24	20.5

DIN EN 560 (left handed thread marked)

\* only for STP13/09

## STP Hose Tail, short

Brass



ØD	C		L
4	G1/8	<b>STP10/04</b>	27.5
6	G1/8	<b>STP10/06</b>	28
4	G1/4	<b>STP13/04</b>	30.5
6	G1/4	<b>STP13/06</b>	35.5
9	G1/4	<b>STP13/09*</b>	35.5
6	G3/8	<b>STP17/06</b>	36
9	G3/8	<b>STP17/09</b>	36
9	G1/2	<b>STP21/09</b>	38
13	G1/2	<b>STP21/13</b>	44

## STD Hose Tail, long

Brass



ØD	C		L
4	G1/4	<b>STD13/04</b>	47
6	G1/4	<b>STD13/06</b>	47
4	G3/8	<b>STD17/04</b>	47.5
6	G3/8	<b>STD17/06</b>	47.5
9	G3/8	<b>STD17/09</b>	47.5

DIN EN 560

## GT Hose Tail Barb

Brass

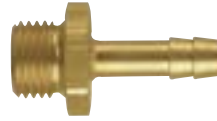

ØD	C		HEX	L
3	M5	<b>GT05/03</b>	7	15.5
4	M5	<b>GT05/04</b>	7	15.5
	M6	<b>GT06/04</b>	8	23
6	G1/2*	<b>GT21/06</b>	24	39
4	G1/8*	<b>GT10/04</b>	14	28
6	G1/8*	<b>GT10/06</b>	14	33
8	G1/8*	<b>GT10/08</b>	14	33
9	G1/8*	<b>GT10/09</b>	14	33
4	G1/4*	<b>GT13/04</b>	17	29.5
6	G1/4*	<b>GT13/06</b>	17	34.5
8	G1/4*	<b>GT13/08</b>	17	34.5
9	G1/4*	<b>GT13/09</b>	17	34.5
10	G1/4*	<b>GT13/10</b>	17	34.5
3	G1/4*	<b>GT13/13</b>	17	41.5
6	G3/8*	<b>GT17/06</b>	19	36
8	G3/8*	<b>GT17/08</b>	19	36
9	G3/8*	<b>GT17/09</b>	19	36
10	G3/8*	<b>GT17/10</b>	19	36
13	G3/8*	<b>GT17/13</b>	19	42
9	G1/2*	<b>GT21/09</b>	24	39
10	G1/2	<b>GT21/10</b>	24	40
13	G1/2*	<b>GT21/13</b>	24	45
16	G1/2	<b>GT21/16</b>	24	53
19	G1/2	<b>GT21/19</b>	24	54
13	G3/4*	<b>GT26/13</b>	32	48.5
16	G3/4*	<b>GT26/16</b>	32	56.5
19	G3/4*	<b>GT26/19</b>	32	56.5
25	G1*	<b>GT33/25</b>	36	67.5

with Male Thread

(\* inner cone 45°)

## GT Hose Tail Barb

Stainless steel



ØD	C		HEX	L	Version
6	G1/8*	<b>GT10/06R</b>	14	33	AISI 303
	G1/8*	<b>GT10/06E</b>	14	33	AISI 316L
9	G1/4*	<b>GT13/09R</b>	17	34.5	AISI 303
	G3/8*	<b>GT17/09R</b>	19	36	AISI 303
13	G1/2*	<b>GT21/13R</b>	24	45	AISI 303

with Male Thread (\* inner cone 45°)

## GI Hose Tail Barb

Brass

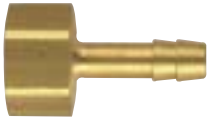

ØD	C		HEX	L
6	G1/8	GI10/06	12	31
8	G1/8	GI10/08	12	31
6	G1/4	GI13/06	17	33
8	G1/4	GI13/08	17	33
9	G1/4	GI13/09	17	33
13	G1/4	GI13/13	17	39
6	G3/8	GI17/06	19	33
8	G3/8	GI17/08	19	33
9	G3/8	GI17/09	19	33
13	G3/8	GI17/13	19	40
6	G1/2	GI21/06	24	36
8	G1/2	GI21/08	24	36
9	G1/2	GI21/09	24	36
13	G1/2	GI21/13	24	43

with Female Thread

## DS Hose Repairer

Brass



ØD		L
4	DS04/04P**	50
6	DS06/06*	72
8	DS08/08*	72
9	DS09/09*	72
13	DS13/13	74

\* DIN EN 560

\*\* for Hard Hoses

## DK Hose Repairer, short

Brass



ØD		L
4	DK04/04	19
6	DK06/06	19

## SM Tube Nut for Plastic Hoses

Brass



ØD	C		HEX	L
3 x 4	M7x0.5	SM04	-	8.5
3 x 5	M7x0.6	SM05	-	8.5
4 x 6	M10x1	SM06	12	11
6 x 8	M12x1	SM08	14	11
8 x 10	M16x1	SM10	17	12.5
9 x 12	M16x1	SM12	17	12.5

## DV Swivelling Spring Guard

Brass



ØD	C		HEX
3.1 x 4.7	R1/8	DV10/05	11
4.8 x 6.3	R1/4	DV13/06	14
6.3 x 7.9	R1/4	DV13/08	14
7.9 x 9.5	R1/4	DV13/10	15
9.5 x 11.8	R3/8	DV17/12	19
12.7 x 15.8	R1/2	DV21/16	22

## SV Fixed Spring Guard

Brass



ØD	C		HEX	L
4 x 6	G1/8	SV10/06	12	103
6 x 8	G1/8	SV10/08	12	106
4 x 6	G1/4	SV13/06	17	103
6 x 8	G1/4	SV13/08	17	106
8 x 10	G1/4	SV13/10	17	119
9 x 12	G1/4	SV13/12	17	123
	G3/8	SV17/12*	19	123

\* Inner Cone 45°

## KN Spring Guard completely with Tube Nut

Brass



ØD	C		HEX	L
4 x 6	M10x1	KN06	12	94
6 x 8	M12x1	KN08	14	97
8 x 10	M16x1	KN10	17	110
9 x 12	M16x1	KN12	17	114

## 0694 Push-In Fitting with Protection Spring, Male BSPP Thread

Nickel-plated Brass, NBR

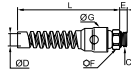

ØD	C		E	F	G	L	Kg
8	G1/4	<b>0694 08 13</b>	6.5	16	24	104.5	0.067
10	G1/4	<b>0694 10 13</b>	6.5	18	24	106.5	0.062
12	G3/8	<b>0694 12 17</b>	7.5	20	29.5	126	0.080

## 0695 Push-In Fitting with Protection Spring, Male BSPT Thread

Nickel-plated Brass, NBR

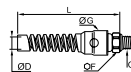

ØD	C		F	G	L	Kg
8	R1/4	<b>0695 08 13</b>	14	24	104.5	0.055
10	R1/4	<b>0695 10 13</b>	18	24	106.5	0.063
12	R3/8	<b>0695 12 17</b>	20	29.5	126	0.090

## KB ,O'-Clips



	Spread mm	Height
<b>KB0709</b>	7 - 9	7
<b>KB0911</b>	9 - 11	7
<b>KB1113</b>	11 - 13	7
<b>KB1315</b>	13 - 15	7.5
<b>KB1518</b>	15 - 18	8
<b>KB1720</b>	17 - 20	8.5
<b>KB2023</b>	20 - 23	9